

7-

FILED

LAND CORNER RECORDATION CERTIFICATE  
Filing Requirement of Act 74, Mich. P.A. 1970

For Corners in BRIGHTON TWP.

1996 DEC -3 P 3:00R

NANCY HAVILAND  
REGISTER OF DEEDS  
LIVINGSTON COUNTY, MI.  
48043

L.S.C.#627m

REGISTER OF DEEDS STAMP & FILE NUMBER

	A	B	C	D	E	F	G	H	I	J	K	L	M
2	6	5	4	3	2	1							
3													
4	7	8	9	10	11	12							
5													
6	18	17	16	15	14	13							
7													
8	19	20	21	22	23	24							
9													
10	30	29	28	27	26	25							
11													
12	31	32	33	34	35	36							
13													

LIVINGSTON  
(COUNTY)

1. Public Land Survey Located In T2N R6E Corner Code # F-11

T\_\_ R\_\_

T\_\_ R\_\_

T\_\_ R\_\_

2. Property Controlling in Section S\_\_ T\_\_ R\_\_

S\_\_ T\_\_ R\_\_

3. Miscellaneous Property in Sec. S\_\_ T\_\_ R\_\_

S\_\_ T\_\_ R\_\_

4. Lot No. \_\_\_\_\_, Recorded Plat \_\_\_\_\_

5. Private Claims \_\_\_\_\_

I, BRYAN L. BOSS in a field survey on NOVEMBER 1, 1996, do hereby certify that under requirements of P.A. 74, Michigan P.A. of 1970, the corner points mentioned in lines 1 and 2 above were in conformance with regulations and rules therefore as required in the current manual of survey instructions of the United States Department of the Interior, bureau of Land Management or by a decree of a Court of Law and/or that the corner points mentioned in lines 3, 4 and 5 above were in conformance with the rules of the Michigan Board of Land Surveyors or by a Decree of a Court of Law, established, re-established, monumented, re-monumented, recovered, found as expressed below:

NOTE: Not more than 4 corners, all in the same town and range, may be recorded on this certificate.

A. Description of original monument and accessories and/or subsequent restoration:

BLACK OAK 20" S 13° W 3.75

BLACK OAK 6" N 02° W .74

YELLOW OAK 10" N 83¼° W 23 LINKS

YELLOW OAK 14" N 24¼° W 38 LINKS

B. Description of corner evidence found and/or applied in restoring or reestablishing corner:

FOUND 3/4" PIPE SET BY ROBERT J. JAGOW R.L.S. #6998

LAND RECORDATION CERTIFICATE NO. 250 DESCRIBES METHOD APPLIED IN

RE-ESTABLISHING WAS 1/4 CORNER SET ON LINE MIDWAY BETWEEN SOUTHWEST

CORNER AND SOUTHEAST CORNER OF SECTION 28.

C. Description of monument for corner and accessories established to perpetuate location the position of the corner:

SET 1¼ X 36" IRON PIPE WITH BRASS CAP STAMPED "LIVINGSTON COUNTY MONUMENTATION CORNER."

N 20° W NAIL & TAG EAST SIDE 42" OAK 33.16'

S 65° W NAIL & TAG NORTH SIDE 24" CHERRY 27.22'

S 10° E NAIL & TAG WEST SIDE 14" CHERRY 11.35'

S 75° E NAIL & TAG NORTH SIDE 12" OAK 32.53'

Signed by Bryan L. Boss

Surveyor's Michigan License No. 29238

Date 11-21-1996

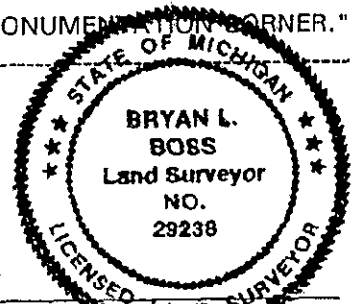

FORM APPROVED BY MICHIGAN STATE BOARD OF LAND SURVEYORS, JAN. 28, 1975  
REVISED MAY 14, 1975  
REVISED JAN., 1983

P.A. 345 1990, APPROVED BY LIVINGSTON COUNTY  
DEED GROUP ON 9-18-96 CO. REP VED

SUMMARY  
F-11

09377

North 1/4 Corner, Section 33, T2N-R6E, Brighton Township, Livingston County, Michigan.

CORNER EVIDENCE

Found 3/4" pipe with Atwell-Hicks plugged cap 10 feet  $\pm$  North of East-West fence line. No occupation North and South.

This area is heavily wooded and not conducive for G.P.S.

DISTANCES

This 1/4 corner was set by Robert J. Jagow on August 3, 1972 (See Act 74 on page 13 of this dossier) on line between Section Corners. Witness sheet on page 12 notes this 3/4" iron pipe was set 10.1 feet North of East and West fence.

Found "Ridge Wood Subdivision No. 1" plat boundary concrete monument 145.28 feet West of North 1/4 corner (page 18).

The only surveys in dossier that refer to point F-11 are Design (page 16) and new Plat (page 18). Both of these surveys use the Jagow Pipe.

WITNESSES

Survey by Desine Incorporated in 1992, found pipe at South 1/4 corner, Section 28 and witnesses checked with Jagow Act 74 Land Corner Recordation Certificate.

September 13, 1996 Boss Engineering witnesses agree with description by Robert J. Jagow on August 13, 1972.

RECOMMENDATION

We recommend acceptance of Jagow point as found.

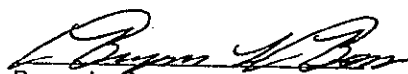
  
Bryan L. Boss

