

OCT 26 1995

COMMISSION

LAND CORNER RECORDATION CERTIFICATE
Filing Requirement of Act 74, Mich. P.A. 1970

Oct 4 3 19 PM '95
NANCY HAYLAND
REGISTER OF DEEDS
LIVINGSTON COUNTY, MI
48843

FILED

or corners in

Livingston	Located In:	Corner Code ##
(County)		
Public Land Survey	T <u>2N</u> R <u>6E</u>	<u>G-11</u>
	T _____ R _____	_____
	T _____ R _____	_____
	T _____ R _____	_____
Property Controlling	S _____ T _____ R _____	_____
in Section	S _____ T _____ R _____	_____
Miscellaneous	S _____ T _____ R _____	_____
Property in Sec.	S _____ T _____ R _____	_____

L.S.C. #444 m

Register of Deeds Stamp & File Number

Lot No. _____, Recorded Plat _____
Private Claims _____

	A	B	C	D	E	F	G	H	I	J	K	L	M
2	6		5		4		3		2		1		
3													
4	7		8		9		10		11		12		
5													
6	18		17		16		15		14		13		
7													
8	19		20		21		22		23		24		
9													
10	30		29		28		27		26		25		
11													
12	31		32		33		34		35		36		
13													

Bryan Boss, in a field survey on 8-10, 19 95,
do hereby certify that under requirements of P.A. 74, Michigan P.A. of 1970, the corner points mentioned
in lines 1 and 2 above were in conformance with regulations and rules therefore as required in the
current manual of survey instructions of the United States Department of the Interior, Bureau of Land
Management or by a decree of a Court of Law and/or that the corner points mentioned in lines 3, 4 and 5
above were in conformance with the rules of the Michigan Board of Land Surveyors or by a Decree of a
Court of Law; established, re-established, monumented, re-monumented, recovered, found as
expressed below:

NOTE: Not more than 4 corners, all in the same town and range, may be recorded
on this certificate.

A. Description of original monument and accessories and/or subsequent restoration:

Set post corner to Sections 27, 28, 33, & 34
Black Oak 20" N 82 W 4.98
White Oak 10" N 12 E 1.89
Yellow Oak 10" S 7 W 27 links
Yellow Oak 10" N 18 E 131 1/2 links

B. Description of corner evidence found and/or method applied in restoring or reestablishing corner:

3/8" iron pipe found
L.S.C. # 1445 Chris Newman R.L.S. # 24607 witnesses
N 45° E 8.68' 12" Cherry
West 17.59' 18" Oak
West 20.70' 36" Oak
South 17.33' 30" Oak

C. Description of monument for corner and accessories established to perpetuate locating the position of the corner:

Set brass cap in 36" pipe 4" inches below grade
20.78' S 80° W nail & tag South side 42" Oak
8.53' N 30° E nail & tag Southeast side 8" Twin Cherry
17.51' East nail & tag South side 20" Oak
17.32' S 10° W nail & tag West side 32" dead Oak

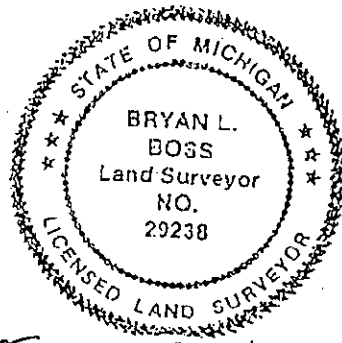

Signed by Bryan L. Boss

Date Sept. 28, 1995

Surveyor's Michigan License No. 29238

FORM APPROVED BY MICHIGAN STATE BOARD OF LAND SURVEYORS, JAN. 28, 1971
REVISED MAY 14, 1975
REVISED JAN., 1993

P.A. 345 1990, APPROVED BY LIVINGSTON COUNTY
PEER GROUP ON 4-19-95, CO. REP JED

SUMMARY
G-11

NORTHWEST CORNER, SECTION 34, T2N-R6E BRIGHTON TOWNSHIP,
LIVINGSTON COUNTY, MICHIGAN.

Found 3/8" iron pipe 0.3'± above ground surface at Southwest corner of wood corner post. Remnants of fence in all four directions. This location is in a heavy wooded area, which will be difficult for G.P.S..

Witnesses and distances among four surveyors check.

On page 11 this dossier, J. Teller field notes witnesses Northeast corner of section 33 with an oak S 7 W 27 links (17.82 feet) in 1886. This witness coincides with witness #2 on page 7 this dossier.

Conclusion: We recommend acceptance of 3/8" iron pipe as found.

BRIG-11S

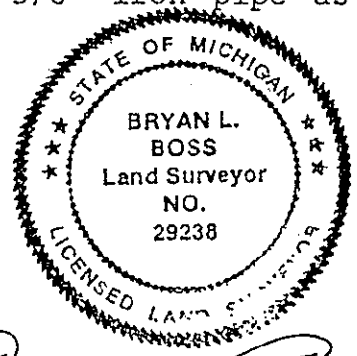

Bryan L. Boss