

SURVEY &  
REMONUMENTATION

FEB 26 2001

FILED

SECTION

LAND CORNER RECORDATION CERTIFICATE  
Filing Requirement of Act 74, Mich. P.A. 1970

For corners in

LIVINGSTON Located in: Corner Code #  
(County)  
1. Public Land Survey T 3 N R 3 E F-03  
T R  
T R  
T R  
2. Property Controlling S T R  
in Section S T R  
3. Miscellaneous S T R  
Property in Sec. S T R

2000 OCT 30 A 9:23

NANCY HAVILAND  
REGISTER OF DEEDS  
LIVINGSTON COUNTY, MI.  
48843

LSC #1343m

Register of Deeds Stamp & File Number

4. Lot No. \_\_\_\_\_, Recorded Plat \_\_\_\_\_  
5. Private Claims \_\_\_\_\_

I, JACK K. SMITH, in a field survey on OCTOBER 11, 2000 do hereby state that under requirements of P.A. 74, Michigan P.A. of 1970, the corner points mentioned in lines 1 and 2 above were in conformance with regulations and rules therefore as required in the current manual of survey instructions of the United States Department of the Interior, Bureau of Land Management or by a decree of a Court of Law and /or that the corner points mentioned in lines 3, 4 and 5 above were in conformance with the rules of the Michigan Board of Land Surveyors or by a Decree of a Court of Law; established, re-established, monumented, recovered, found as expressed below:

NOTE: Not more than 2 corners, all in the same town and range, may be recorded on this certificate.

A. Description of original monument and accessories and/or subsequent restoration:

GLO 1825 SYLVESTER SIBLEY SET POST  
TAMARAC 26" N8 1/2°W 35.64'  
TAMARAC 6" S61 1/2°E 66.00'

B. Description of corner evidence found and/or method applied in restoring or reestablishing corner:

THE EXISTING CORNER IS A SPIKE IN A WOODEN FENCE POST AT THE INTERSECTION OF FENCE LINES NORTH, SOUTH AND EAST. THIS MATCHES OCCUPATION WELL.

C. Description of monument for corner and accessories established to perpetuate locating the position of the corner:

F-03 NORTH 1/4 CORNER SECTION 8, T3N, R3E, HANDY TOWNSHIP, LIVINGSTON COUNTY, MICHIGAN:  
SET 1 1/4" x 36" STEEL PIPE WITH LIVINGSTON COUNTY REMONUMENTATION BRASS CAP STAMPED SURVEYOR #35999 IN PLACE OF THE SPIKE IN THE FENCE POST.

N60°E SPIKE AND LIV. CO. REMON TAG IN NW SIDE OF 8" WOODEN FENCE POST 0.32'  
S50°W SPIKE AND LIV. CO. REMON TAG IN WEST SIDE OF 10" ELM 8.40'  
S20°W SPIKE AND LIV. CO. REMON TAG IN EAST SIDE OF 10" ELM 28.50'  
N35°W 1" PIPE WITH LIVINGSTON COUNTY REMON BRASS WITNESS CAP 10.00'

Signed by [Signature] Date 10-16-2000

Surveyor's Michigan License No. 35999

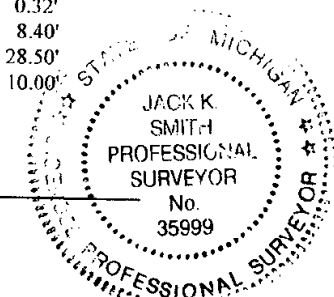

FORM APPROVED BY MICHIGAN STATE BOARD OF PROFESSIONAL SURVEYORS, JAN. 28, 1971

P.A. 345 1990, APPROVED BY LIVINGSTON COUNTY

PEER GROUP ON 4-19-2000 CO. REP JED

REVISED MAY 14, 1975

REVISED JAN. 1983

REVISED OCT. 1995