

MACKINAC COUNTY REMONUMENTATION CORNER

LAND CORNER RECORDATION CERTIFICATE Filing Requirement of Act 74, Mich. P.A. 1970

For corners in
MACKINAC

Located In:

Corner Code #

(County)

1. Public Land Survey

T 44N R 12W

#1

T _____ R _____

T _____ R _____

T _____ R _____

2. Property Controlling
in Section

S _____ T _____ R _____

S _____ T _____ R _____

3. Miscellaneous
Property in Sec.

S _____ T _____ R _____

S _____ T _____ R _____

RECEIVED & FILED
DIANE FRANKOVICH
MACKINAC COUNTY REGISTER OF DEEDS

NOV 15 1996

AM

PM

7|8|9|10|11|12|1|2|3|4|5|6

Register of Deeds Stamp & File Number

4. Lot No. _____, Recorded Plat _____

5. Private Claims _____

I, JAMES H. GRANGER, in a field survey on AUGUST 28, 19 96
do hereby state that under requirements of P.A. 74, Michigan P.A. of 1970, the corner points
mentioned in lines 1 and 2 above were in conformance with regulations and rules therefore as
required in the current manual of survey instructions of the United States Department of the Interior,
Bureau of Land Management or by a decree of a Court of Law and /or that the corner points
mentioned in lines 3, 4 and 5 above were in conformance with the rules of the Michigan Board of
Land Surveyors or by a Decree of a Court of Law; established, re-established, monumented,
recovered, found as expressed below:

NOTE: Not more than 2 corners, all in the same town and range, may be recorded
on this certificate.

	A	B	C	D	E	F	G	H	I	J	K	L	M
1													
2	6		5		4		3		2		1		
3													
4	7		8		9		10		11		12		
5													
6	18		17		16		15		14		13		
7													
8	19		20		21		22		23		24		
9													
10	30		29		28		27		26		25		
11													
12	31		32		33		34		35		36		
13													

A. Description of original monument and accessories and/or subsequent restoration:

1849 - Original Survey Set wood post 16" Maple S30°E 45 lks
W. Burt

SURVEY &
REMONUMENTATION

MAY 20 1997

COMMISSION

B. Description of corner evidence found and/or method applied in restoring or reestablishing corner:

Found a 3/4" iron at the ENE 1/16 corner which was approx. 75' away from the waters edge. Extended line from the E 1/4 corner of
Section 13 thru the 1/16 corner and placed corner at shore.

ACCEPTED BY THE MACKINAC COUNTY
SURVEY PEER GROUP AS THE
OFFICIAL CORNER UNDER P.A.
345 OF 1990 AT A MEETING
HELD ON 8-29-96

James H. Granger

C. Description of monument for corner and accessories established to perpetuate locating the position of the corner:

Also M.C. Corner, T44N, R11W

Set 5/8" x 30" rebar with Remonumentation Cap

3/4" Rod	S04°W	57.37'	Set tag
4" Elm	S86°W	23.21'	Set tag
5" Maple	N68°E	44.28'	Set tag
5" maple	S86°E	34.23'	Set tag

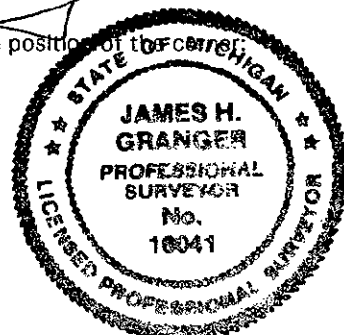

Signed by James H. Granger

Date 10-10-96

Surveyor's Michigan License No. 16041