

DEC 19 2000

MONTCALM COUNTY REMONUMENTATION PROGRAM

LAND CORNER RECORDATION CERTIFICATE

Filing Requirement of Act 74, Mich. P.A. 1970

SECTION

For corners in

Montcalm

(County)

Located In:

Evergreen Township

Corner Code #

C-13

STATE OF MICHIGAN
MONTCALM COUNTY
RECORDED

26 JUN 2000 9:34:07 AM

LORI A. WILSON
REGISTER OF DEEDS

Register of Deeds Stamp & File Number

1. Public Land Survey Sec. 31,32 T 10 N R 06 W

T R

T R

T R

T R

2. Property Controlling
in Section

S T R

S T R

3. Miscellaneous
Property in Sec.

S T R

S T R

4. Lot No. Recorded Plat

5. Private Claims

I, William G. Tingley, in a field survey on April 19, 2000, do hereby certify that under requirements of P.A. 74, Michigan P.A. of 1970, the corner points mentioned in lines 1 and 2 above were in conformance with regulations and rules therefore as required in the current manual of survey instructions of the United States Department of the Interior, Bureau of Land Management or by a decree of a Court of Law and/or that the corner points mentioned in lines 3, 4 and 5 above were in conformance with the rules of the Michigan Board of Land Surveyors or by a Decree of a Court of Law; established, re-established, monumented, re-monumented, recovered, found as expressed below:

NOTE: Not more than 2 corners, all in the same town and range, may be recorded on this certificate.

A. Description of original monument and accessories and/or subsequent restoration:

1. May 23, 1837, Noah Brookfield, Deputy Surveyor, GLO notes, West on south side Section 32.

Set post corner of Sections 31, 32 at 80.00 chains

W. oak 12" N45°W 37 links (24.42 feet)

Maple 10" N15°E 23 links (15.18 feet)

2. 1969, George Stevenson card file, T10N-R-06W #117 at Tingley and Associates office

SE Corner Section 31 south boundary. Found 2" iron bar with drill mark in center.

SW corner house N50°E 74.60 feet

Tele. pole w/con. Box S60°E 62.70 feet

NE cor. sec.6 T9-R6 East 19.00 feet

ACCEPTED BY THE MONTCALM COUNTY SURVEY PEER
GROUP AS THE OFFICIAL CORNER UNDER MICHIGAN
PUBLIC ACT 345 OF 1990 AT A MEETING HELD 6/14/00.

3. May 11, 1988, Richard J. Crater # 16924, LCRC Liber 002 Page 214

Found solid iron bar

SW corner house N50°E 74.60 feet

Tele. Box S60°E 64.30 feet

WGT
William Tingley, PS, Chairman

4. December 31, 1997, William G. Tingley, # 30104, Certificate of Survey Liber 817 Page 721

Found solid iron bar

Power pole S36°W 137.10 feet

RR spike E/S PP S50°W 63.20 feet

SW corner house N65°E

N/T E/S Tele pole N02°W 32.95 feet

NE cor. Sec 6

T9N-R-6W East 19.00 feet



LIBER 4

PAGE 242

B. Description of corner evidence found and/or method applied in restoring or reestablishing corner:

Searched apparent location of the corner. Excavated 4.00 feet x 5.00 feet x 4.00 feet deep. Found a truck axle shaft with the flange at bottom of asphalt. The shaft is 1 1/2" x 3.00 feet with the end of the shaft on an 8" rock. No other evidence found.

C. Description of monument for corner and accessories established to perpetuate locating the position of the corner:

Set remonumentation pipe over axle shaft with the flange sitting on top of the 8" rock.

End N/T NE/S 23" walnut N75°E 79.50 feet

T/C phone riser S21°W 54.97 feet

T/C phone riser N03°E 32.97 feet

End N/T W/S 13" maple N28°E 45.75 feet

T09N-R-06W C-01 East 19.16 feet

This corner is accepted as the best available evidence of the position of the original corner.

Bearings given are magnetic. Standard remonumentation pipe consists of a Berntsen stainless steel 2 3/8" x 1/2" cap stamped "MONTCALM COUNTY REMONUMENTATION, P.S. # 30104"

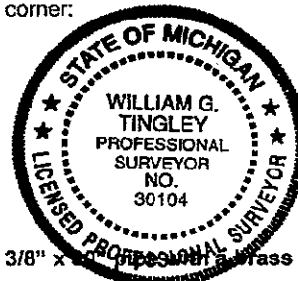

Signed by

William G. Tingley

Date

6/14/00

Surveyor's Michigan License No.

30104

FORM APPROVED BY MICHIGAN STATE BOARD OF LAND SURVEYORS, JAN. 28, 1971
REVISED MAY 14, 1975
REVISED JAN., 1983
ADAPTED FOR WORD PROCESSING MARCH, 1993