

SURVEY &
REMONUMENTATION

LIBER 1952 PAGE 582

LAND CORNER RECORDATION CERTIFICATE

Filing Requirement of Act 74, Mich. P.A. 1970

For corners in
MUSKEGON

MAR 21 1997

COMMISSION

Corner Code #

1. Public Land Survey

T 11N R 18W

K-4

T R

T R

T R

2. Property Controlling
in Section

S T R

S T R

3. Miscellaneous
Property in Sec.

S T R

S T R

4. Lot No. , Recorded Plat

5. Private Claims

Stephen V. Vallier, P.S.

November 7

96

I, in a field survey on 19 do hereby certify that under requirements of P.A. 74, Michigan P.A. of 1970, the corner points mentioned in lines 1 and 2 above were in conformance with regulations and rules therefore as required in the current manual of survey instructions of the United States Department of the Interior, Bureau of Land Management or by a decree of a Court of Law and/or that the corner points mentioned in lines 3, 4 and 5 above were in conformance with the rules of the Michigan Board of Land Surveyors or by a Decree of a Court of Law; established, re-established, monumented, re-monumented, recovered, found as expressed below:

NOTE: Not more than 4 corners, all in the same town and range, may be recorded on this certificate.

A. Description of original monument and accessories and/or subsequent restoration:

1837 G.L.O. SET CORNER

SOUTH 09° EAST

7.80 LINKS

15" PINE

1922 SURVEY REFLECTS EAST QUARTER CORNER of SECTION 11 AND DISTANCE TO PARCEL DIVISION AT EIGHTH LINE.

1937 EDWIN WILSON SUBDIVISION RECORDED LIBER 9 OF PLATS, PAGE 15, SHOWS PRINTS ON EAST/WEST QUARTER LINE, BUT NO DISTANCE TO QUARTER CORNER.

* SEE ATTACHED EXHIBIT "K-4"

B. Description of corner evidence found and/or method applied in restoring or reestablishing corner:

FOUND 1/2" ROD IN MONUMENT BOX OVER A 1" PINCHED PIPE.

NORTHWEST

108.36' NORTHWEST

CORNER OF TENNIS COURT

ACCEPTED POSITION OF CORNER DUE TO HISTORICAL USAGE AND DOCUMENTATION OF RECORD.

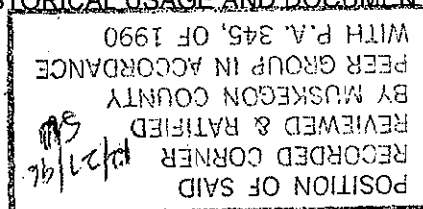
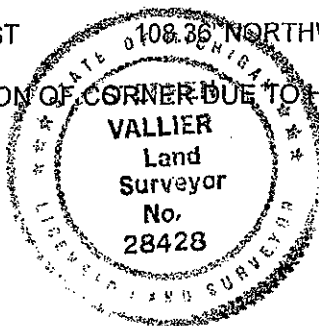

C. Description of monument for corner and accessories established to perpetuate locating the position of the corner:

REPLACED 1/2" X 26" IRON PIPE IN MONUMENT BOX WITH 2 3/4" X 30" CAST IRON MONUMENT WITH COUNTY SURVEY CAP.

SOUTH 16° EAST

81.72'

POWER POLE

FOUND SPIKE

NORTH 36° EAST

108.36'

NORTHWEST CORNER OF TENNIS COURT

WEST

126.82

NORTHEAST CORNER OF FOUNDATION

NORTH 21° EAST

43.87'

1/2" IRON ROD

SOUTH 41° WEST

97.48'

8-12" TWIN POPLAR

FOUND SPIKE

NORTH 10° WEST

105.24'

14" POPLAR

SET NAIL ON WEST SIDE

SOUTH 77° EAST

132.97'

SOUTHWEST CORNER CONCRETE BLOCK SHED

Signed by

Stephen V. Vallier

Date

12/24/96

Surveyor's Michigan License No.

28428

EXHIBIT "K-4"

- 1937 BEECHMENT WOODS SUBDIVISION RECORDED LIBER 9 OF PLATS PAGES 22 & 23.
SHOWS POINTS ALONG EAST/WEST QUARTER LINE, BUT NO DISTANCE TO QUARTER CORNER.
- 1964 F.F. SMITH - FOUND CONCRETE MONUMENT.
- | | | |
|--------------------|---------|-------------------------------|
| NORTH 35° EAST | 108'± | NORTHWEST CORNER TENNIS COURT |
| WEST - SOUTHWEST | 100.60' | 14" TREE |
| SOUTH | 22.50' | 8" TREE |
| SOUTH - SOUTH/EAST | 63.55 | 6" TREE |
- 1974 PLAT OF THE VILLAGE NO. 1 RECORDED IN LIBER 20 OF PLATS, PAGE 7.
EAST QUARTER CORNER IS SHOWN AS CONCRETE MONUMENT.
- 1987 MOORE & BRUGGINK FOUND ½" IRON ROD IN MONUMENT BOX.