

LAND CORNER RECORDATION CERTIFICATE
Filing Requirement of Act 74, Mich. P.A. 1970

For corners in

MENOMINEE
(County)

Located In:

Corner Code: J-5

1. Public Land Survey

33N 27W

J-5

T R

T R

T R

T R

2. Property Controlling
in Section

S T R

S T R

3. Miscellaneous
Property in Sec.

S T R

S T R

4. Lot No. , Recorded Plat

5. Private Claims

RECEIVED FOR RECORD
55 NOV -8 AM 11:29
PAGE # 216 BK 4
DAVID RLS
REGISTERED LAND SURVEYOR
MENOMINEE, WISCONSIN

Register of Deeds Stamp & File Number

	A	B	C	D	E	F	G	H	I	J	K	L	M
2	6	5	4	3	2	1							
3													
4	7	8	9	10	11	12							
5													
6	18	17	16	15	14	13							
7													
8	19	20	21	22	23	24							
9													
10	30	29	28	27	26	25							
11													
12	31	32	33	34	35	36							
13													

William Lenca

OCT. 19

95

I, William Lenca, in a field survey on OCT. 19, 1995

do hereby certify that under requirements of P.A. 74, Michigan P.A. of 1970, the corner points mentioned in lines 1 and 2 above were in conformance with regulations and rules therefore as required in the current manual of survey instructions of the United States Department of the Interior, Bureau of Land Management or by a decree of a Court of Law and/or that the corner points mentioned in lines 3, 4 and 5 above were in conformance with the rules of the Michigan Board of Land Surveyors or by a Decree of a Court of Law; established, re-established, monumented, re-monumented, recovered, found as expressed below:

NOTE: Not more than 4 corners, all in the same town and range, may be recorded on this certificate.

A. Description of original monument and accessories and/or subsequent restoration:

1848: Original Survey by John H. Mullett - B.T.'s - Hemlock, 8" - S65°E - 05 lks; Birch, 10" - N62°W - 17 lks. All original evidence for this corner has been destroyed by farming activities.

1985: L.C.R.C. No. 714 recorded by William Lenca, RLS No. 26461, states a 1" x 24" Iron Pipe was set at the intersection of ancient fences running E-W & S. Ties: 25" dia. W. Pine - S54°E - 72.66 feet; 24" dia. W. Pine - South - 123.17 feet; 8" dia. Ironwood - West - 142.57 feet.

3. Description of corner evidence found and/or method applied in restoring or reestablishing corner:

We recovered a 1" x 24" iron pipe at the intersection of ancient fences running East - West and South from this location, and 3 B.T.'s as described in L.C.R.C. No. 714 above. We accepted this corner location as the best available evidence of the position of the original corner.

2. Description of monument for corner and accessories established to perpetuate locating the position of the corner:

Set 5/8" x 24" Iron Rod/3-1/4" dia. Alum. cap stamped for corner location in Monument Box:

25" dia. White Pine	S54°E	72.66 feet
24" dia. White Pine	South	123.17 feet
10" dia. Ironwood	West	142.57 feet
Metal Survey Sign Post		

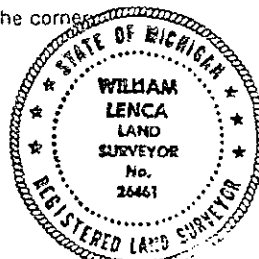

NOTE: All bearings are magnetic bearings. All distances are measured with steel tape. Distances to trees are to nail in side of tree.

Signed by William Lenca

Date

OCT. 20, 1995

Surveyor's Michigan License No. 26461