

MAR 29 2000

SECTION

LAND CORNER RECORDATION CERTIFICATE
Filing Requirement of Act 74, Mich. P.A. 1970

Approved by Menominee County
Land Survey Remonumentation
Peer Group Under Act 345 of

P.A. of 1999 On 12/18, 1999
McLarvin RLS
Chairman

For corners in

MENOMINEE
(County)

Located In:

Corner Code #

- | | | |
|------------------------------------|---|-------------|
| 1. Public Land Survey | T <u>35</u> N R <u>28</u> W | <u>K-12</u> |
| | T <u> </u> R <u> </u> | <u> </u> |
| | T <u> </u> R <u> </u> | <u> </u> |
| | T <u> </u> R <u> </u> | <u> </u> |
| 2. Property Controlling in Section | S <u> </u> T <u> </u> R <u> </u> | <u> </u> |
| | S <u> </u> T <u> </u> R <u> </u> | <u> </u> |
| 3. Miscellaneous Property in Sec. | S <u> </u> T <u> </u> R <u> </u> | <u> </u> |
| | S <u> </u> T <u> </u> R <u> </u> | <u> </u> |

BK. 6 Pg. 76

RECEIVED FOR RECORD
28 DEC 1999 3:56:09 PM
BARBARA MORRISON
REGISTER OF DEEDS
MENOMINEE, MI 49858

Register of Deeds Stamp & File Number

4. Lot No. , Recorded Plat
5. Private Claims

I, William Lenca, in a field survey on Dec., 19 99 do hereby state that under requirements of P.A. 74, Michigan P.A. of 1970, the corner points mentioned in lines 1 and 2 above were in conformance with regulations and rules therefore as required in the current manual of survey instructions of the United States Department of the Interior, Bureau of Land Management or by a decree of a Court of Law and /or that the corner points mentioned in lines 3, 4 and 5 above were in conformance with the rules of the Michigan Board of Land Surveyors or by a Decree of a Court of Law; established, re-established, monumented, recovered, found as expressed below:

NOTE: Not more than 2 corners, all in the same town and range, may be recorded on this certificate.

	A	B	C	D	E	F	G	H	I	J	K	L	M
1													
2		6		5		4		3		2		1	
3													
4		7		8		9		10		11		12	
5													
6		18		17		16		15		14		13	
7													
8		19		20		21		22		23		24	
9													
10		30		29		28		27		26		25	
11													
12		31		32		33		34		35		36	
13													

A. Description of original monument and accessories and/or subsequent restoration:

- 1852: Original Survey by Francis Coleman - B.T.'s - Y. Pine, 18" - N28°W - 36 lks.; W. Pine, 14" - S45°E - 08 lks. All original evidence for this corner has been destroyed by logging activities.
1987: L.C.R.C. Number 778 by William Lenca states, "Set Corner at location of ancient fence corner. This location fits well with GLO terrain calls North and distance South to the Menominee River." Set 5/8" x 24" Iron Rod / Identification cap marked "MI 26461/WI 1569". TIES: W. Birch, 6" - N30°E - 25.49'; Maple, 6" - S30°E - 26.49'; Oak, 20" - S63°W - 37.33'.

B. Description of corner evidence found and/or method applied in restoring or reestablishing corner:

We recovered a 5/8 inch x 24 inch re-rod with plastic identification cap at an ancient fence corner with fences running South and West. We also recovered the 3 B.T.'s as described in LCRC No. 778 (see part "A"). There are remains of 2 old Pine stumps fitting closely with the location of the Original B.T.'s, but are too rotted to identify conclusively. This corner fits well with a GLO call to the foot of a ridge 1.3 chains North, and is accepted as the best available evidence of the position of the original corner.

C. Description of monument for corner and accessories established to perpetuate locating the position of the corner:

Set 3/4" dia. x 4' long aluminum rod/3-1/4" dia. Alum. cap stamped for corner.

6" dia. Maple	N55°E	22.57 feet	Scr. NBT
7" dia. Maple (Ex. B.T.)	S30°E	26.49 feet	Scr. NBT
22" dia. Oak (Ex. B.T.)	S63°W	37.33 feet	Scr. NBT
14" dia. Oak	N40°W	49.38 feet	Scr. NBT
Metal Survey Sign Post	West	1.1 feet	

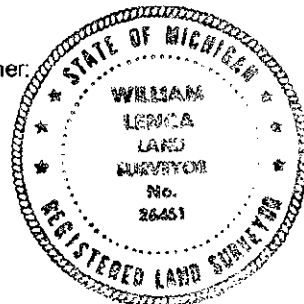

NOTE: All bearings are magnetic bearings. All distances are measured with steel tape. Distances to trees are to nail in side of tree.

Signed by William Lenca
Surveyor's Michigan License No. 26461

Date Dec. 17, 1998