

MAR 29 2000

SECTION

LAND CORNER RECORDATION CERTIFICATE
Filing Requirement of Act 74, Mich. P.A. 1970

Approved by Menominee County
Land Survey Remonumentation
Peer Group Under Act 345 Of
P.A. Of 1990 On 12/23, 1999
Mike Davis RLS
Chairman

For corners in

MENOMINEE
(County)

Located In:

Corner Code #

1. Public Land Survey T 35NR 27W A-02
T R
T R
T R
2. Property Controlling S T R
in Section S T R
3. Miscellaneous S T R
Property in Sec. S T R

BA. 6 Pg. 83

RECEIVED FOR RECORD
28 DEC 1999 3:56:09 PM
BARBARA MORRISON
REGISTER OF DEEDS
MENOMINEE, MI 49858

Register of Deeds Stamp & File Number

4. Lot No. Recorded Plat
5. Private Claims
(SAME AS CORNER M-02 T35N - R28W)

I, William Lenca, in a field survey on Nov., 19 99 do hereby state that under requirements of P.A. 74, Michigan P.A. of 1970, the corner points mentioned in lines 1 and 2 above were in conformance with regulations and rules therefore as required in the current manual of survey instructions of the United States Department of the Interior, Bureau of Land Management or by a decree of a Court of Law and /or that the corner points mentioned in lines 3, 4 and 5 above were in conformance with the rules of the Michigan Board of Land Surveyors or by a Decree of a Court of Law; established, re-established, monumented, recovered, found as expressed below:

NOTE: Not more than 2 corners, all in the same town and range, may be recorded on this certificate.

	A	B	C	D	E	F	G	H	I	J	K	L	M
1													
2	6		5		4		3		2		1		
3													
4	7		8		9		10		11		12		
5													
6	18		17		16		15		14		13		
7													
8	19		20		21		22		23		24		
9													
10	30		29		28		27		26		25		
11													
12	31		32		33		34		35		36		
13													

A. Description of original monument and accessories and/or subsequent restoration:

1847: Original Survey by H. Floyd - B.T.'s - Sugar, 12" - N56°W - 60 lks.; Hemlock, 20" - S46°W - 47 lks. All original evidence for this corner has been destroyed by logging activities.

B. Description of corner evidence found and/or method applied in restoring or reestablishing corner:

In a retracement of the West Line of Section 6, T35N-R27W, we found a 12 inch diameter Cedar Post set at the intersection of ancient fences running South East and West at a distance of 2670.83 feet South of the NW Corner of Section 6 and at a distance of 2640.15 feet North of the SW Corner of Section 6. We accepted the position of the large Cedar Post at the fence intersection as the best available evidence of the position of the original corner.

C. Description of monument for corner and accessories established to perpetuate locating the position of the corner:

Set 2" dia. Aluminum Pipe 30" long 3/4" dia. Alum cap stamped for corner location:

8" dia. Oak	N13°E	24.49 feet	Scr. NBT
7" dia. Maple	S75°E	20.03 feet	Scr. NBT
10" dia. Maple	S13°E	16.26 feet	Scr. NBT
9" dia. Hemlock	West	15.83 feet	Scr. NBT
Metal Survey Sign Post	East	2.1 feet	

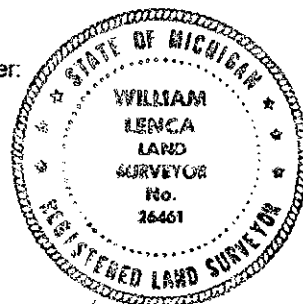

NOTE: All bearings are magnetic bearings. All distances are measured with steel tape. Distances to trees are to nail in side of tree.

Signed by William Lenca
Surveyor's Michigan License No. 26461

Date Nov. 26, 1999