

# LAND CORNER RECORDATION CERTIFICATE Filing Requirement of Act 74, Mich. P.A. 1970

Approved by Menominee County  
Land Survey Remonumentation  
Peer Group Under Act 345 Of  
P.A. Of 1990 On 12/27, 1996  
Mc Davis RLS  
Chairman

For corners in

MENOMINEE  
(County)

Located In:

Corner Code #

1. Public Land Survey

T 37N R 25W

D01

T 38 R 25

D-13 ✓

2. Property Controlling  
in Section

S

T

R

3. Miscellaneous  
Property in Sec.

S

T

R

S

T

R

4. Lot No. \_\_\_\_\_, Recorded Plat \_\_\_\_\_

5. Private Claims \_\_\_\_\_

SAME AS CORNER D-13, T38N-R25W

I, William Lenca, in a field survey on Jun 11, 1996 do hereby state that under requirements of P.A. 74, Michigan P.A. of 1970, the corner points mentioned in lines 1 and 2 above were in conformance with regulations and rules therefore as required in the current manual of survey instructions of the United States Department of the Interior, Bureau of Land Management or by a decree of a Court of Law and/or that the corner points mentioned in lines 3, 4 and 5 above were in conformance with the rules of the Michigan Board of Land Surveyors or by a Decree of a Court of Law; established, re-established, monumented, recovered, found as expressed below:

NOTE: Not more than 2 corners, all in the same town and range, may be recorded on this certificate.

A. Description of original monument and accessories and/or subsequent restoration:

1847: Original Survey by James H. Mullett - B.T.'s - Cedar, 4" - N36°W - 09 lks.; Cedar, 6" - N69°E - 29 lks. All original evidence for this corner has been destroyed by farming activities.

B. Description of corner evidence found and/or method applied in restoring or reestablishing corner:

We set this corner in line with the centerline of county roads running North and West, and with an ancient fence line running East. This corner fits reasonably well with measurements to corners 1/2 mile East and 1/2 mile West, and is accepted as the best available evidence of the position of the original corner.

C. Description of monument for corner and accessories established to perpetuate locating the position of the corner:  
Set 2" dia. Aluminum Pipe/3-1/4" dia. Alum. cap stamped for corner location:

5/8" x 24" Iron Rod/2" dia. Alum. cap marked "WITNESS MARKER"  
5/8" x 24" Iron Rod/2" dia. Alum. cap marked "WITNESS MARKER"  
5/8" x 24" Iron Rod/2" dia. Alum. cap marked "WITNESS MARKER"  
Metal Survey Sign Post

N39°E 48.98 feet  
S82°W 100.97 feet  
N64°W 76.83 feet  
East 33.80 feet

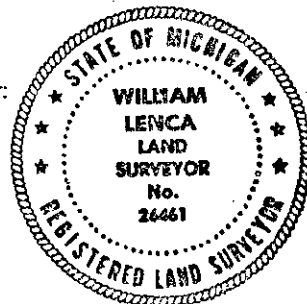

NOTE: All bearings are magnetic bearings. All distances are measured with steel tape. Distances to trees are to nail in side of tree.

Signed by William Lenca  
Surveyor's Michigan License No. 26461

Date Dec. 19, 1996