

SURVEY & REMONUMENTATION

JAN 18 2001

SECTION

LAND CORNER RECORDATION CERTIFICATE

Filing Requirement of Act 74, Mich. P.A. 1970

STATE OF MICHIGAN
COUNTY OF OCEANA
RECEIVED FOR RECORD

21 DEC 2000 3:10:29 PM

JOSEPH E. MERTEN
REGISTER OF DEEDS
100985

Register of Deeds Stamp & File Number

For corners in

Oceana

(County)

Located In:

Corner Code #

1. Public Land Survey

T 16N R 16W

F-9

T R

T R

T R

T R

2. Property Controlling
in Section

S

T R

S

T R

3. Miscellaneous
Property in Sec.

S

T R

S

T R

4. Lot No. , Recorded Plat

5. Private Claims

I, J. Randolph Hepworth, in a field survey on June 19, 2000, do hereby state that under requirements of P.A. 74, Michigan P.A. of 1970, the corner points mentioned in lines 1 and 2 above were in conformance with regulations and rules therefore as required in the current manual of survey instructions of the United States Department of the Interior, Bureau of Land Management or by a decree of a Court of Law and/or that the corner points mentioned in lines 3, 4 and 5 above were in conformance with the rules of the Michigan Board of Land Surveyors or by a Decree of a Court of Law; established, re-established, monumented, recovered, found as expressed below:

NOTE: Not more than 2 corners, all in the same town and range, may be recorded on this certificate.

	A	B	C	D	E	F	G	H	I	J	K	L
1												
2	6	5	4	3	2	1						
3												
4	7	8	9	10	11	12						
5												
6	18	17	16	15	14	13						
7												
8	19	20	21	22	23	24						
9												
10	30	29	28	27	26	25						
11												
12	31	32	33	34	35	36						
13												

A. Description of original monument and accessories and/or subsequent restoration:

F-9 1/4 CORNER COMMON TO SECTIONS 21 & 28 T16N, R16W

CRYSTAL TOWNSHIP

GLO J. Hodgson 1838 SET POST 12" Beech N42°E 23 lks 6" Ironwood S40°W 23 lks
Book A, Pg. 350, H. A. Grant, 1894; Sec 28, T16N, R16W Corner not described.

Consumers Power Co., S-F17051, Blass Surveys, 1968, To be reset in line with C1/4 & S1/4

Recorded Survey, Jkt # 176, Richardson & Nordlund, Inc.; James Nordlund LS16345, 7/6/76 Set

1) Iron Due South 33.0'

2) Nail in fence post N30°E 24.90'

3) Nail in fence post N45°E 37.20'

B. Description of corner evidence found and/or method applied in restoring or reestablishing corner.

I found a 1/2" Rebar Iron with no cap 6' North of centerline of E-W Road and on old fence/occupation to North. No occupation is visible to the south. C.P. Co. (Blass) did not set or find this corner, but only calculated its position. Nordlund, 1976, apparently set this Iron using Blass calculated position. No other iron object was detected after excavation and removal. All Nordlund witnesses are standing and measure OK.

I accept the 1/2" Iron as the best available evidence of the position of the original corner. No evidence is known to me that would lead me to believe the corner should be at another location.

C. Description of monument for corner and accessories established to perpetuate locating the position of the corner:

Set 4"x20" Harrison Cast Iron Monument, stamped "County Surveyor" and "26457" above the 1/2" Iron which was driven down

Set 60d spk NE Face 5" tw Cedar

115°az 185.14'

EDM

ex. 16d spk/shiner W Face Fence Post

8°az 25.28'

EDM

set 60d spk NW Face 10" Willow

54°az 49.41'

EDM

set 60d spk SW Face Power Pole

332°az 93.16'

EDM

1) Found R-N capped 1/2" Iron

South 33.03'

EDM

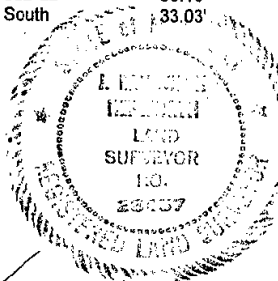

Oceana County Remonumentation
Peer Group Reviewed & Approved

Date: 11-21-00

J. Randolph Hepworth
Oceana County Surveyor

Signed by

J. Randolph Hepworth

Date

December 15, 2000

Surveyor's Michigan License No.

26457