

LAND CORNER RECORDATION CERTIFICATE

Filing Requirement of Act 74, Mich. P.A. 1970

Ontonagon County

Page 1 of 1

LC 5/287

Date 06/12/2000

Time 16:30:39

RECORDING FEE:

9.00

For corners in

Ontonagon County	Located in:	Corner Code #
1. Public Land Survey	T52N R39W	K-6
	T R	
	T R	
	T R	
2. Property Controlling	S T R	
in Section	S T R	
3. Miscellaneous	S T R	
Property in Sec.	S T R	
4. Lot No.	Recorded Plat	
5. Private Claims		

SURVEY & REMONUMENTATION

MAR 02 2001

SECTION

Register of Deeds Stamp & File Number

A	B	C	D	E	F	G	H	I	J	K	L	M
1												
2	6	5	4	3	2	1						
3												
4	7	8	9	10	11	12						
5												
6	18	17	16	15	14	13						
7												
8	19	20	21	22	23	24						
9												
10	30	29	28	27	26	25						
11												
12	31	32	33	34	35	36						
13												

I, Joseph C. Domitrovich, in a field survey on May 22, 2000, do hereby state that under requirements of P.A. 74, Michigan P.A. of 1970, the corner points mentioned in lines 1 and 2 above were in conformance with regulations and rules therefore as required in the current manual of survey instructions of the United States Department of the Interior, Bureau of Land Management or by a decree of a Court of Law and/or that the corner points mentioned in lines 3, 4 and 5 above were in conformance with the rules of the Michigan Board of Land Surveyors or by a Decree of a Court of Law; established, re-established, monumented, recovered, found as expressed below:

NOTE: Not more than 2 corners, all in the same town and range, may be recorded on this certificate.

A. Description of original monument and accessories and/or subsequent restoration:

(K-6) ¼ Corner Common to Sections 13 & 14, T52N, R39W.

1845 - William A. Burt set a Fir Post with ties:

6" Fir	N 68°E	15 links
16" Cedar	N 57°W	12 links

1953 - Ned and John Hawley, Timber Cruisers, placed a ½" galvanized pipe in an East - West fence on the extension of a fence south of highway, ¼ Tally to the South.

1981 - Robert Mick, P.S. 18936, in corner form recorded in Liber 2, Page 3, of Corner Records, calls for a 1" iron pipe. Blazed lines found on old fence line. This pipe is 2657.75' East of Center of Section 14.

B. Description of corner evidence found and/or method applied in restoring or reestablishing corner:

I found no remains of the original corner or accessories. I found ½" x 60" (¾" O.D.) galvanized iron pipe in an old East - West fence line, approximately 170' North of Lakeshore Road. I believe this is the pipe set by the Hawley's. It works well with Section Corner to the North and it has been used to establish the center ¼ corner of Section 14. It is probably the same pipe recorded by Mick but my measured distance to the center ¼ corner differs from his. I accepted this iron pipe as the true ¼ corner.

Research on file with County Remonumentation Representative.

C. Description of monument for corner and accessories established to perpetuate locating the position of the corner:

Corner is a 2 ½" x 30" aluminum pipe with a 3" diameter aluminum cap stamped to read: COUNTY REMONUMENTATION; T52N, R39W; ¼ S. 14, S. 13; 2000; P.S. 37273. Corner falls on old E - W fence line and 46' South of a logging Road.

5" Soft Maple	N 15°E	26.43'	(Existing Blaze)
Sign Rail	East	0.65'	(To Face)
8" Hard Maple	S 14°E	6.62'	
8" Soft Maple	S 55°W	24.26'	
18" Poplar	N 54°W	7.30'	(Existing Blaze)
NE Cor. Sec. 14	N 00°40'47"W	2638.42'	
Center ¼ Sec. 14	N 89°58'45"E	2633.41'	(Stamped cap placed inside of 1 ½" wood pipe)

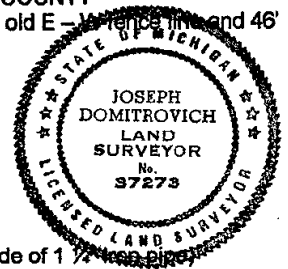

NOTE: Bearings to witness objects are magnetic. Distances are to a nail in side of the witness object unless noted.

Signed by

Date

5/24/00

Surveyor's Michigan License No. 37273