

SURVEY & REMONUMENTATION

NOV 01 1999

LAND CORNER RECORDATION CERTIFICATE Filing Requirement of Act 74, Mich. P.A. 1970

SECTION

For corners in

Osceola

(County)

Located In:

Corner Code #

1. Public Land Survey

17N 7W

H-5

2. Property Controlling
in Section

S T R

3. Miscellaneous
Property in Sec.

S T R

4. Lot No. , Recorded Plat
5. Private Claims

Robert L. Wetherell, in a field survey on Aug. 9, 1999 do hereby state that under requirements of P.A. 74, Michigan P.A. of 1970, the corner points mentioned in lines 1 and 2 above were in conformance with regulations and rules therefore as required in the current manual of survey instructions of the United States Department of the Interior, Bureau of Land Management or by a decree of a Court of Law and /or that the corner points mentioned in lines 3, 4 and 5 above were in conformance with the rules of the Michigan Board of Land Surveyors or by a Decree of a Court of Law; established, re-established, monumented, recovered, found as expressed below:

NOTE: Not more than 2 corners, all in the same town and range, may be recorded on this certificate.

H-5 - S 1/4 Corner of Section 10, T17N, R7W

A. Description of original monument and accessories and/or subsequent restoration:

1848 - O. Lyon

#1 - 11" Hemlock N20E 20 Links
#2 - 18" Pine S48W 38 Links

1891 - 1904 - A. Temple/F. Trumbull

Remonumentation of T17N, R7W
Set 3" Clay Tiles
"Stake & O.B.T. piece of iron"
#3-20" Pine stump S18 1/2 E 45 Lks.
#4-22" Pine stump N34 1/2 W 57 1/2 Lks

(SEE OVER FOR CONTINUATION OF "A")

B. Description of corner evidence found and/or method applied in restoring or reestablishing corner:

I found the Osceola County Monument by McClung in line with fence to South and 4' North of Fence Line to East, and in line with road to West. I also found Lapham's capped iron 3.35' South and 0.3' West of the County Monument. I accepted the County Monument and removed the capped iron.

Condition of the accessories are as follows: #1 Gone, #2 Gone, #3 Gone, #4 Gone, #5 Gone, #6 Gone, #7 down, #8 Gone, #9 Found in good condition, #10 Found in good condition, #11 Found in good condition, #12 Found in good condition.

C. Description of monument for corner and accessories established to perpetuate locating the position of the corner:

I accept the Osceola County Monument (1 1/2" pipe with Osceola County Remon Cap) as a substantial marker for the corner and is accepted as a careful and faithful Perpetuation of the position of the original corner.

4" Iron Gate Post S16E 9.55' #9
4" Iron Gate Post S04E 29.45' #10
3" Steel Gate Post N52W 33.65' #11
3" Steel Gate Post N30W 24.05' #12

Signed by Robert L. Wetherell
Surveyor's Michigan License No. 24624

Date 8-26-99

APPROVED LAND CORNER
P.A. 345 OF 1990
Osceola County

8-26-99

R. L. W.

FORM APPROVED BY MICHIGAN STATE BOARD OF PROFESSIONAL SURVEYORS, JAN. 28, 1971
REVISED MAY 14, 1975
REVISED JAN., 1983
REVISED OCT., 1985

	A	B	C	D	E	F	G	H	I	J	K	L	M
1													
2	6			5			4		3		2		1
3													
4	7			8			9		10		11		12
5													
6	18			17			16		15		14		13
7													
8	19			20			21		22		23		24
9													
10	30			29			28		27		26		25
11													
12	31			32			33		34		35		36
13													

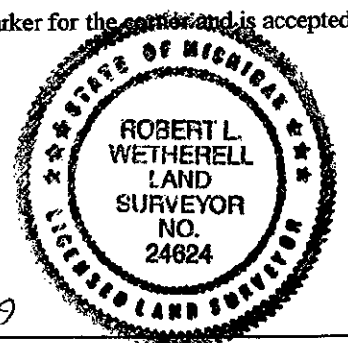

CONTINUATION OF DESCRIPTION OF ORIGINAL MONUMENT AND ACCESSORIES AND/OR SUBSEQUENT RETORATION.

1977 - Lapham LS 9433

LCRC

L.2, Pg. 27

Fd. T Iron

Set ½" Capped Re-Rod

#5 - Cor. Fence Post North 26.72'

#6 - Center 4" Steel Fence Post South 5.6'

#7 - Corner Fence Post East 1.53'

#8 - Sq. Gate Post N45W 34.70'

1998 - McClung 13037

Survey Record

L. 645 Pg. 114

Fd. Tile & Iron

Set Osceola County Monument

#9 - 4" Iron Gate Post S16E 9.55'

#10 - 4" Iron Gate Post S04E 29.45'

#11 - 3" Steel Gate Post N52W 33.65'

#12 - 3" Steel Gate Post N30W 24.05'

OSCEOLA COUNTY
REGISTER OF DEEDS
99 SEP -3 AM 11:48

James C. Cline

SURVEY &
REMONUMENTATION

NOV 01 1999

SECTION