

FEB 24 2000

## SECTION

**LAND CORNER RECORDATION CERTIFICATE**  
FILING REQUIREMENT OF ACT 74, Mich. P.A. 1970

**For corners in  
Osceola**

**Located in:**

**Corner Code#**

1. Public Land Survey \_\_\_\_\_ S \_\_\_\_\_ E \_\_\_\_\_
2. Property Controlling in Section \_\_\_\_\_ S \_\_\_\_\_ E \_\_\_\_\_
3. Miscellaneous Property in Sec. \_\_\_\_\_ S \_\_\_\_\_ E \_\_\_\_\_
4. Lot No. \_\_\_\_\_ Recorder \_\_\_\_\_ S \_\_\_\_\_ E \_\_\_\_\_
5. Private Claims \_\_\_\_\_ S \_\_\_\_\_ E \_\_\_\_\_

[illegible]

Register of Deeds Stamp & File Number

I, Robert L. Wetherell, in a field survey on October 1 1999, do hereby certify that under requirements of P.A. 74, Michigan P.A. of 1970, the corner points mentioned in lines 1 and 2 above were in conformance with regulations and rules therefore as required in the current manual of survey instructions of the United States Department of the Interior, Bureau of Land Management or by decree of a Court of Law and/or that the corner points mentioned in lines 3, 4, and 5 above were in conformance with the rules of the Michigan Board of Land Surveyors or by a Decree Of a Court of Law, established, re-established, monumented, re-monumented, recovered, found as expressed below:

**NOTE: ONLY ONE CORNER MAY BE RECORDED ON THIS CERTIFICATE.**  
**¼ Corner common to Sec. 34 & 35**

**A. Description of original monument and accessories and/or subsequent restoration:**

1838 J. Hodgson  
#1-6" Lynn N31W9 Lk.  
#2- 7" Beech S36E 38 Lks

Undated- Lincoln Twp. Book  
Front Pages Pg. 5- Bolt  
#3- 16" Elm West 29.5"  
#4- 16" Elm SW 59.8"

1902 Lincoln Twp Book  
Page 2 & 3 - Iron Bolt  
Dist North 2584'

**(SEE OVER FOR CONTINUATION OF "A")**

**B. Description of corner evidence found and/or method applied in restoring or reestablishing corner:**  
I found an Osceola County Monument in the C/L of the North end of the road.  
The road at this location has been widened.

I found an Osceola County Monument in the C/L of the North and South Road and in line with the fence to the East and West. The road at this location has been cut +/- 5'.

Condition of the accessories are as follow: #1 Cap - 55 condition, #7 Fence - 55 condition.

Condition of the accessories are as follow: #1 Gone, #2 Gone, #3 Gone, #4 Gone, #5 Found in good condition, #6 Found in good condition, #7 Found in good condition, #8 Found in good condition and #9 Found in good condition.

I believe that the chain used by the surveyor in 1902 was not properly calibrated because other distances (as measured today) between the corners are proportionally longer than they were in 1902.

C. Description of monument for corner -

C. Description of monument for corner and accessories established to perpetuate locating the position of the corner:  
I accepted the Osceola County Monument (1 1/2" pipe with an Osceola County Monument cap) and is accepted as a careful and faithful copy of the original monument.

I accepted the Osceola County Monument (1 1/2" pipe with an Osceola County Remon Cap) as a substantial marker of the corner and is accepted as a careful and faithful reestablishment of the position of the original corner.

6" Con. Filled Post S65E 37.65' (Center) #6  
6" Con. Filled Post S40E 48.05' (Center) #9  
P. Pole S25E 63.1' (Nail on SW side) #5  
20" Maple S22W 63.95' (Nail on SE side) #7

Signed by

Surveyor's Michigan License No. 24624

Date Nov. 9, 1999

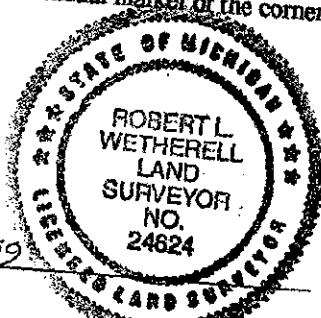

APPROVED LAND CORNER  
P.A. 345 OF 1990  
Osceola County

10-21-99

5340

FORM APPROVED BY MICHIGAN STATE BOARD OF LAND SURVEYORS, JAN. 28, 1971  
REVISED MAY 14, 1975  
REVISED JAN., 1983  
ADAPTED FOR WORD PROCESSING JANUARY, 1989

CONTINUATION OF DESCRIPTION OF THE ORIGINAL MONUMENT AND ACCESSORIES AND/OR SUBSEQUENT AND RESTORATION.

1994 Wetherell- LS 24624

LCRC

L. 3, Pg. 98

Fd. Iron pin with a hex head.

#5- P. Pole S22E 62.90'

#6- Gate Post (6" pipe filled with conc.) S59E 37.6'

#7- 18" Maple S28W 64.04'

#8- 4" Cherry (No spike in tree) S62W 30.0'

Dist. North 2614.82'

RF SURVEY & 1

1998 McClung LS 13037

Unrecorded Survey

Fd. Iron Pin with Hex Head

Set Osceola Co. Monument

#6- 6" Con. Filled Post (Center) S65E 37.65'

#9- 6" Con. Filled Post (Center) S40E 48.05'

#5- P. Pole (Nail on SW side) S25E 63.1'

#7- 20" Maple (Nail on SE side) S22W 63.95'

Dist. North 2614.79'

FEB 24 2000

SECTION

OSCEOLA COUNTY  
REGISTER OF DEEDS  
99 NOV 19 PM 12:10  
Nancy Crawford