

OTTAWA COUNTY REMONUMENTATION

RECORDED

LAND CORNER RECORDATION CERTIFICATE  
Filing Requirement of Act 74, Mich. P.A. 1970

97 JUL 24 PM 2: 24

For corners in  
Ottawa

Located In:

Corner Code #

(County)

Chester Twp.

9N 13W

I-12, W1/4 cor.

1. Public Land Survey

T R

Sec. 35

T R

T R

T R

2. Property Controlling  
in Section

S

T R

S

T R

3. Miscellaneous  
Property in Sec.

S

T R

S

T R

*Register of Deeds*  
REGISTER OF DEEDS  
OTTAWA COUNTY, MI

Register of Deeds Stamp & File Number

4. Lot No. \_\_\_\_\_, Recorded Plat \_\_\_\_\_  
5. Private Claims \_\_\_\_\_

I, Randal D. Feenstra, in a field survey on Oct 10, 19 96 do hereby state that under requirements of P.A. 74, Michigan P.A. of 1970, the corner points mentioned in lines 1 and 2 above were in conformance with regulations and rules therefore as required in the current manual of survey instructions of the United States Department of the Interior, Bureau of Land Management or by a decree of a Court of Law and /or that the corner points mentioned in lines 3, 4 and 5 above were in conformance with the rules of the Michigan Board of Land Surveyors or by a Decree of a Court of Law; established, re-established, monumented, recovered, found as expressed below:

NOTE: Not more than 2 corners, all in the same town and range, may be recorded on this certificate.

	A	B	C	D	E	F	G	H	I	J	K	L	M
1													
2		6		5		4		3		2		1	
3													
4		7		8		9		10		11		12	
5													
6		18		17		16		15		14		13	
7													
8		19		20		21		22		23		24	
9													
10		30		29		28		27		26		25	
11													
12		31		32		33		34		35		36	
13													

A. Description of original monument and accessories and/or subsequent restoration:

G.L.O.	L-6, P-106, (1991)		
Rasselas Whitcomb (1838)	Cast Iron Monument		
7" Beech S72°E 18.5'	16" Cherry	WSW	50.27'
10" Maple N59°W 15.8'	12" Cherry	ESE	33.38'
	5" Apple	SE	73.35'
	12" Walnut	NW	88.74'

P.A. 345 OTTAWA COUNTY

PEER APPROVED

10-21-96

B. Description of corner evidence found and/or method applied in restoring or reestablishing corner:  
I-12 Found: Cast Iron Monument

Nail in N side 16" Cherry WSW 50.41'

Accepted as a careful and faithful perpetuation of the position of the original corner

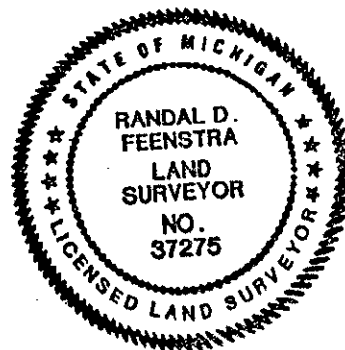

C. Description of monument for corner and accessories established to perpetuate locating the position of the corner:

I-12 Cast Iron Monument		
Nail and Ottawa County Remon Tag W side 8" Poplar	N25°E	68.13'
Nail and Ottawa County Remon Tag W side 4" Elm	S70°E	20.23'
Nail and Ottawa County Remon Tag E side 6" Elm	S20°W	14.42'
Nail and Ottawa County Remon Tag S side 4" Elm	N60°W	17.51'
Found Iron 6' ± SE of Monument		
5' W of centerline 16th Ave. unimproved		

Signed by Randal D. Feenstra  
Surveyor's Michigan License No. 37275

Date October 10, 1996