

LAND CORNER RECORDATION CERTIFICATE
Filing Requirement of Act 74, Mich. P.A. 1970 as Amended

For corners in

Ontonagon

(County)

Located In:

Corner Code #

1. Public Land Survey

T 51N R 37W

68

T R

T R

S T R

2. Property Controlling
in Section

S T R

S T R

3. Miscellaneous

S T R

Property in Sec.

S T R

Register of Deeds Stamp & File
Number

4. Lot No. , Recorded Plat

5. Private Claims

May 24 2006

I, Stephan J. Szyszkoski, in a field survey on _____, 20____ do hereby state that under requirements of P.A. 74, Michigan P.A. of 1970, the corner points mentioned in lines 1 and 2 above were in conformance with regulations and rules therefore as required in the current manual of survey instructions of the United States Department of the Interior, Bureau of Land Management or by a decree of a Court of Law and /or that the corner points mentioned in lines 3, 4 and 5 above were in conformance with the rules of the Michigan Board of Land Surveyors or by a Decree of a Court of Law; established, re-established, monumented, recovered, found as expressed below:

NOTE: Not more than 2 corners, all in the same town and range, may be recorded on this certificate.

A. Description of original monument and accessories and/or subsequent restoration:

(68) Quarter corner common to Sections 21 and 22. 1846 - Established by S.W.Higgins, Deputy Surveyor: North between Sections 21 & 22 ...40.00 Set 1/4 Sec. post. Sugar 12 N40W 90 links, Sugar 9 S70E 80 links. ...80.00 Set post corner of Sections 15, 16, 21, 22. 1976 - Recovered by K.L.Sackett PS: Original monument and accessories not found. Found 1" I.D. iron pipe 3 feet above ground. Reestablished corner at iron pipe. Fits good with other corners in area. 9" Elm N47E 5.4', 5" Sugar S69W 14.9', 5" Sugar N19W 14.1'.

B. Description of corner evidence found and/or method applied in restoring or reestablishing corner:

(68) Using the monumented locations of corners 69 and 1/16th corner #10 of Section 22, I produced a line northerly and recovered the 1" pipe monument of record at 68. The pipe had been disturbed, driven into the ground and bent over by heavy equipment. The lower portion of the pipe was still set vertically and marks the position of the corner. Found no evidence of the 1976 NBTs. Straightened the found iron pipe and placed an aluminum MDNR cap on it. Made new witnesses as described below.

C. Description of monument for corner and accessories established to perpetuate locating the position of the corner:

(68) Found 1"x40" I.pipe. Set 4" alum.
MDNR cap atop. Set measuring nails in:
7" Sugar N63W 19.6' mrkd "1/4S NBT"
6" Sugar N37E 14.2' do
12" Sugar S77E 22.0' do
9" Sugar S13W 22.3' do
Set sq'd sugar post adjacent. Bearings
are magnetic. Distances are to nail
with tag.

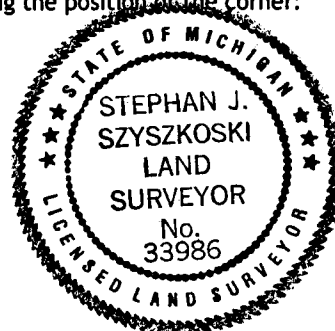

Signed by

Stephan J. Szyszkoski

Date

6/19/06

Surveyor's Michigan License No.

33986

For the Michigan Department of Natural Resources, Office of Land and Facilities

FORM APPROVED BY MICHIGAN STATE BOARD OF PROFESSIONAL SURVEYORS, JAN. 28, 1971

Revised May 14, 1975

Revised Jan., 1983

Revised Oct., 1995