

1995 STATE OF MICHIGAN REMONUMENTATION
PRESQUE ISLE COUNTY
RECORDED

2645- JAN 17 1996

LAND CORNER RECORDATION CERTIFICATE
COMMISSION Filing Requirement of Act 74, Mich. P.A. 1970

For corners in

Presque Isle
(County)

Located In:

Corner Code ##

1. Public Land Survey T 36N 2E E2
T R
T R
T R
T R
2. Property Controlling S T R
in Section S T R
3. Miscellaneous S T R
Property in Sec. S T R

95 DEC 14 AM 10:28
J. M. S. S. S.
REGISTER OF DEEDS

LIBER 316 PAGE 932

Register of Deeds Stamp & File Number

4. Lot No. , Recorded Plat
5. Private Claims

I, James A. Beck, in a field survey on Oct 18, 1995, do hereby certify that under requirements of P.A. 74, Michigan P.A. of 1970, the corner points mentioned in lines 1 and 2 above were in conformance with regulations and rules therefore as required in the current manual of survey instructions of the United States Department of the Interior, Bureau of Land Management or by a decree of a Court of Law and/or that the corner points mentioned in lines 3, 4 and 5 above were in conformance with the rules of the Michigan Board of Land Surveyors or by a Decree of a Court of Law; established, re-established, monumented, re-monumented, recovered, found as expressed below:

NOTE: Not more than 4 corners, all in the same town and range, may be recorded on this certificate.

	A	B	C	D	E	F	G	H	I	J	K	L	M
2	6	5	4	3	2	1							
3													
4	7	8	9	10	11	12							
5													
6	18	17	16	15	14	13							
7													
8	19	20	21	22	23	24							
9													
10	30	29	28	27	26	25							
11													
12	31	32	33	34	35	36							
13													

A. Description of original monument and accessories and/or subsequent restoration:

E2 1856: Set post and referenced:
Government Resurvey Cedar 9" N29°W 32 Links
* by Geo. H. Cannon Aspen 8" S64°E 22 Links

B. Description of corner evidence found and/or method applied in restoring or reestablishing corner:

E2 October 18, 1995 Set 1/2" iron rod and P.S. 21559 cap
Remonumentation by by single proportionate methods to
James A. Beck P.S. 21559 corner Sections 4, 5, 8 and 9 and corner
4 and 5 on Township line
No original evidence found

Ratified by Peer Group
in accordance with P.A. 345
Chairman
Date 11/21/95

C. Description of monument for corner and accessories established to perpetuate locating the position of the corner:

E2 October 18, 1995 Set 1/2" iron rod and P.S. 21559 cap
Remonumentation by Witnesses:
James A. Beck P.S. 21559 S 63°E 15.72', 3" Maple
S 30°W 44.10', 1" Cedar
S 73°W 29.41', 7" Hemlock
N 43°W 27.12', 2" Balsam
P.S. 21559 witness tags set in witness trees

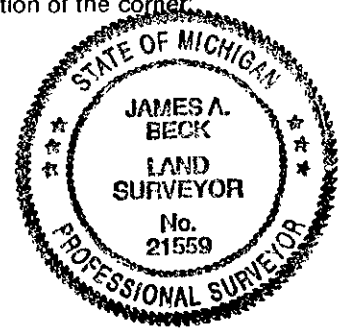

Signed by James A. Beck Date 11-28-1995
Surveyor's Michigan License No. 21559