

MICHIGAN
DEPARTMENT OF CONSERVATION
FORESTRY DIVISION

LAND CORNER RECORD

T. 21 N. R. 3 W

Roscommon COUNTY

DESCRIPTION OF CORNER W 1/8 corner on S. side Section 31 on 2nd correction line

CORNER MONUMENT Set 1" x 24" pipe and post

DATE MONUMENT PLACED AND WITNESSED June 22, 1966

WITNESSES TO CORNER.....

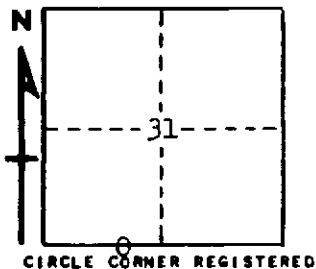

BT 7" Balsam N 70 E 11.5'

BT 8" Balsam N 85 W 9.0'

AND

DESCRIPTION IN DETAIL AS TO HOW CORNER WAS LOCATED AND IDENTIFIED OR RESTORED.

This corner was set by proportionate measurement between restored corners to delineate state land boundary.

SURVEYOR'S SEAL

SIGNED Kenneth J. Ostling DATE June 23, 1966
REGISTERED LAND SURVEYOR #12068