

# LAND CORNER RECORDATION CERTIFICATE

Filing Requirement of Act 74, Mich. PA 1970

For Corners In:  
Roscommon  
(County)

Located In

Corner Code #

1. Public Land Survey	T	R	
	T	R	
2. Property Controlling in Section	S 27	T 22N	R 3W 6
	S 27	T 22N	R 3W 7
3. Miscellaneous Property in Section	S	T	R
	S	T	R

4. Lot No: Recorded Plat:

5. Private Claims:

I, Carl T. Kiiskila, in a field survey on March 18 2010 do hereby state that under requirements of PA 74, Michigan PA of 1970, the corner points mentioned in lines 1 and 2 above were in conformance with regulations and rules therefore as required in the current manual of survey instructions of the United States Department of the Interior, Bureau of Land Management or by a decree of a Court of Law and/or that the corner points mentioned in lines 3, 4 and 5 above were in conformance with the rules of the Michigan Board of Land Surveyors or by a Decree of a Court of Law; established, re-established, monumented, recovered, found as expressed below:

**NOTE: Not more than 2 corners, all in the same town and range, may be recorded on this certificate.**

Register of Deeds Stamp & File Number

	A	B	C	D	E	F	G	H	I	J	K	L	M
1													
2	6		5			4		3		2		1	
3													
4	7		8			9		10		11		12	
5													
6	19		17			16		15		14		13	
7													
8	18		20			21		22		23		24	
9													
10	30		29			28		27		26		25	
11													
12	31		32			33		34		35		36	
13													

A. Description of original monument and accessories and/or subsequent restoration:

6 – NE 1/16 Corner, Section 27, T22N,R3W

7 – N 1/16 Corner, comm. to sec.'s 26 & 27, T22N,R3W

1962 – Survey Map – George D. Henning, P.S.#2240 – Set ½" bar and post. 8" J. Pine N 70°W 34.5'  
8" B. Oak N 73°E 15.4'

1981 – Survey Map – Plan. No. R-72-V – K.J. Ostling, P.S.#10068 – Set 5/8"x30" iron bar.  
1986 – L.C.R.C. – L.1, p.244 – Carl R. Johnson, P.S.#30083 – Reset corner at location prev. est. by K. J. Ostling in 1981, set midway & online between sec. cor. To North & ¼ cor. to South. Set 5/8" CIR#10068  
Power Pole S38°E 45.0'  
SW Corner Cement block bldg. N65°E 38.2'  
20" R. Oak N25°W 41.34'  
8" J. Pine N47°W 35.14'

B. Description of corner evidence found and/or method applies in restoring or re-establishing corner:

6 – NE 1/16 Corner, Section 27, T22N,R3W

7 – N 1/16 Corner, comm. to sec.'s 26 & 27, T22N,R3W

Found ½" bar per Survey Map by Henning. ½" bar falls 2.08' from calculated position for NE 1/16 corner per BLM procedure. Did not accept the found bar as the position for the corner. Set stamped 2" dia. Alum. cap on 5/8"x34" rebar per standard BLM procedure. Found no other evidence to dispute the location for the corner.

Found and accepted 5/8" CIR#10068 per L.C.R.C. - L.1, p.244. Found no other evidence to dispute the location for the corner. Accepted found 5/8" CIR as the best available evidence for the position of the corner.

C. Description of monument for corner and accessories established to perpetuate locating the position of the corner:

6 – NE 1/16 Corner, Section 27, T22N,R3W

7 – N 1/16 Corner, comm. to sec.'s 26 & 27, T22N,R3W

2" dia. Aluminum cap on 5/8"x34" rebar

Found 5/8"CIR#10068.

Wit: N16°E 7.21' to set N&T on SE side 6" J. Pine  
S64°E 12.32' to set N&T on E side 4" R. Oak  
S26°W 8.96' to set N&T on S side 4" R. Oak  
N88°W 11.00' to set N&T on SW side 4" Maple  
North 2.08' to fd. ½" bar  
Set Blue Carsonite post w/location tag 1' North.

Wit: \*N67°E 38.20' to SW cor. of foundation of conc. blk. bldg.  
\*S50°E 44.92' to fd. N&T on SW side Power Pole  
S82°W 1.97' to set N&T on N side 13" J. Pine  
\*N32°W 40.95' to set N&T on SW side 33" R. Oak  
Set Blue Carsonite post w/location tag 1' North.

Witnessed and recorded witness.

Carl T. Kiiskila

Surveyor's Michigan License No.: 33981

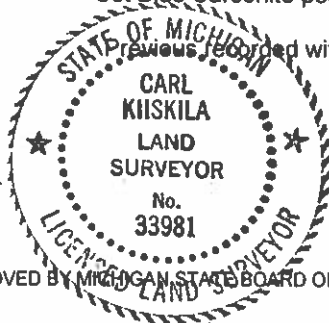

4-12-10