

SURVEY & REMONUMENTATION

8281

APR 24 1995

LAND CORNER RECORDATION CERTIFICATE **COMMISSION** Filing Requirement of Act 74, Mich. P.A. 1970

STATE OF MICHIGAN
ROSCOMMON COUNTY
RECORDED

For corners in

<u>Roscommon</u> (County)	Located In:	Corner Code #
1. Public Land Survey	T 23N R 4W	E - 9
	T R	
	T R	
	T R	
2. Property Controlling in Section	S T R	
	S T R	
3. Miscellaneous Property in Sec.	S T R	
	S T R	
4. Lot No. _____, Recorded Plat _____		
5. Private Claims _____		

10 NOV 94 3:27 P.M.

ROBERT W. SMITH
REGISTER OF DEEDS

ROSCOMMON COUNTY

PEER GROUP APPROVAL

DATE 9-15-94

Register of Deeds Stamp & File Number

I, Marvin E. Myers, in a field survey on September 8, 19 94, do hereby certify that under requirements of P.A. 74, Michigan P.A. of 1970, the corner points mentioned in lines 1 and 2 above were in conformance with regulations and rules therefore as required in the current manual of survey instructions of the United States Department of the Interior, Bureau of Land Management or by a decree of a Court of Law and/or that the corner points mentioned in lines 3, 4 and 5 above were in conformance with the rules of the Michigan Board of Land Surveyors or by a Decree of a Court of Law; established, re-established, monumented, re-monumented, recovered, found as expressed below:

NOTE: Not more than 4 corners, all in the same town and range, may be recorded on this certificate.

A. Description of original monument and accessories and/or subsequent restoration:

GLO-Artemas Curtis 1852	MSHD 8-5-60
Mon-Set Post	Mon- $\frac{1}{2}$ " Steel Rod
WIT: 12" W.Pine N88°W 596 lks.	WIT: None (marsh)
12" W.Pine S85°W 573 lks.	RCRC L.2, pg.424 LCRC
MDOT Ward Abrahamson Nov. 1958	Mon- $\frac{1}{2}$ " Iron Rod aside Gov't Post
Mon-Fd. $\frac{1}{2}$ " Steel rod in abandoned road grad	E. edge of Old Grayling Rd.
WIT: None (marsh)	(on ditch F.S.)

B. Description of corner evidence found and/or method applied in restoring or reestablishing corner:

Monument found $\frac{1}{2}$ " Iron Road 0.5 feet West of 4 inch Cedar Post rotted at water level on foreslope of East ditch line of abandoned North - South road. Accepted $\frac{1}{2}$ " Iron Road and 4 inch Cedar Post as the best available evidence of the position of the original corner.

C. Description of monument for corner and accessories established to perpetuate locating the position of the corner:

Mon-Set 3/4" I.D. x 48" galvanized iron pipe with cap stamped "MEM 31600" over $\frac{1}{2}$ " Iron Rod 0.5' West of 4" Cedar Post on foreslope of East ditch line of abandoned N-S road
WIT: Set Carsonite Post South 3.00'
F-9 S89°00'13"E 2641.72'
E-10 S00°57'53"W 2595.86'
Set nail 10'± W. of W. edge of asphalt in shoulder of S.Bnd. US 27 S32°42'10"E 2654.01'
Set nail in ground 5'± S. of 16" R.Pine N00°56'13"E 600.71'
Set nail in ground S01°59'44"W 1161.11'

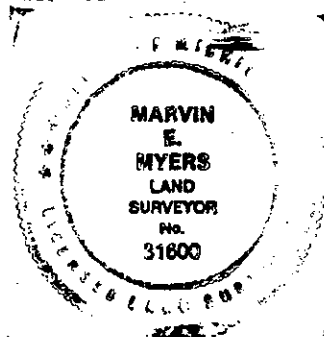

Signed by Marvin E. Myers

Date October 10, 1994

Surveyor's Michigan License No. 31600

FORM APPROVED BY MICHIGAN STATE BOARD OF LAND SURVEYORS, JAN. 28, 1971
REVISED MAY 14, 1975
REVISED JAN., 1983

LIBER 3 PAGE 103