

8288 SURVEY & REMONUMENTATION

APR 24 1995

LAND CORNER RECORDATION CERTIFICATE Filing Requirement of Act 74, Mich. P.A. 1970

STATE OF MICHIGAN
ROSCOMMON COUNTY
RECORDED

For corners in

Roscommon

(County)

COMMISSION

Located In:

Corner Code #

10 NOV 94 3:28 P.M.

ROBERT W. SMITH
REGISTER OF DEEDS

ROSCOMMON COUNTY
PEER GROUP APPROVAL

DATE 9-15-94
Register of Deeds Stamp & File Number

- Public Land Survey T 23N R 4W G - 3
- Property Controlling S T R
- Miscellaneous S T R
- Private Claims

	A	B	C	D	E	F	G	H	I	J	K	L	M
2	6	5	4	3	2	1							
3													
4	7	8	9	10	11	12							
5													
6	18	17	16	15	14	13							
7													
8	19	20	21	22	23	24							
9													
10	30	29	28	27	26	25							
11													
12	31	32	33	34	35	36							
13													

I, Marvin E. Myers, in a field survey on September 12, 1994, do hereby certify that under requirements of P.A. 74, Michigan P.A. of 1970, the corner points mentioned in lines 1 and 2 above were in conformance with regulations and rules therefore as required in the current manual of survey instructions of the United States Department of the Interior, Bureau of Land Management or by a decree of a Court of Law and/or that the corner points mentioned in lines 3, 4 and 5 above were in conformance with the rules of the Michigan Board of Land Surveyors or by a Decree of a Court of Law; established, re-established, monumented, re-monumented, recovered, found as expressed below:

NOTE: Not more than 4 corners, all in the same town and range, may be recorded on this certificate.

A. Description of original monument and accessories and/or subsequent restoration:

GLO-Artemas Curtis 1852	MSHD Norm C. Caldwell	RCRC L.2, pg.399 LCRC
Mon-Set Post	Mon-Fd. 3" Iron Pipe	Mon-
WIT: 12" Aspen N75°E 40 lks.	WIT: P.Pole N64°E 45.98'	WIT: P.Pole N64°E 45.98'
18" Aspen S55°W 25 lks.	10" Poplar N32°E 31.53'	10" Poplar N32°E 31.53'
	Conc. Mon. S14°E 32.70'	Conc. Mon. S14°E 32.70'
Henning/Ostling Dec. 1945	MDOT R/W Plans 1972	
Mon-1 1/4" Pipe	Mon-	
WIT: None	WIT: N.Bnd. C US 27 West 181.90	
MSHD 8-5-60	Larry Cavanagh Nov. 15, 1978	
Mon-3" Iron Pipe	Mon-None L.359, pg.108	
WIT: P.Pole N64°E 45.98'	WIT: P.Pole N64°E 45.98'	
10" Poplar N32°E 31.53'	Poplar N32°E 31.53'	
Conc. Mon. S14°E 32.70'		

B. Description of corner evidence found and/or method applied in restoring or reestablishing corner:

Monument was not found. Verified position by measurement to accessories of record to re-establish position and accepted as the best available evidence of the position of the original corner.

C. Description of monument for corner and accessories established to perpetuate locating the position of the corner:

Mon-Set Std. Roscommon Cty. Mon. stamped "G-3 T23N R4W 31600" 12' NW'ly of C road in shoulder
WIT: Set Wit. Tag & Nail E. side 5" Red Oak N05°W 18.55'
Set Wit. Tag & Nail 12" R.Pine S05°E 50.13'
Fd. nail S. side U.P. N69°E 53.60'
Set Wit. Tag & Nail NW side U.P. S62°W 68.88'
Set Carsonite Post West 18'±
C N. Bnd. US 27 West 182.07'
F-3 N87°52'53"W 2594.89'
G-4 S00°34'36"E 2581.22'
1/8 Cor. Conc. Mon. S00°34'36"E 1290.61'

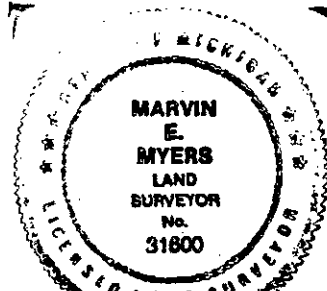

Signed by

Marvin E. Myers

Date

OCT 12 1994

Surveyor's Michigan License No.

31600

FORM APPROVED BY MICHIGAN STATE BOARD OF LAND SURVEYORS, JAN. 28, 1971
REVISED MAY 14, 1975
REVISED JAN., 1983

LIBER 3 PAGE 110