

LAND CORNER RECORDATION CERTIFICATE  
Filing Requirement of Act 74, Mich. P.A. 1970

STATE OF MICHIGAN  
ROSCOMMON COUNTY  
RECORDED

For corners in

**SURVEY &  
REMONUMENTATION**

Roscommon  
(County)

Located In:

Corner Code ##

APR 24 1995

1. Public Land Survey T 24N R 2W H - 3  
COMMISSION  
T  
T  
T  
2. Property Controlling S T R  
in Section S T R  
3. Miscellaneous S T R  
Property in Sec. S T R  
4. Lot No. , Recorded Plat  
5. Private Claims

21 DEC 94 8:37 A.M.

ROBERT W. SMITH  
REGISTER OF DEEDS

Register of Deeds Stamp & File Number

I, Marvin E. Myers, in a field survey on May 3, 19 94  
do hereby certify that under requirements of P.A. 74, Michigan P.A. of 1970, the corner points mentioned  
in lines 1 and 2 above were in conformance with regulations and rules therefore as required in the  
current manual of survey instructions of the United States Department of the Interior, Bureau of Land  
Management or by a decree of a Court of Law and/or that the corner points mentioned in lines 3, 4 and 5  
above were in conformance with the rules of the Michigan Board of Land Surveyors or by a Decree of a  
Court of Law; established, re-established, monumented, re-monumented, recovered, found as  
expressed below:

**NOTE: Not more than 4 corners, all in the same town and range, may be recorded  
on this certificate.**

A. Description of original monument and accessories and/or subsequent restoration:

GLO-June 1852 Burt  
Mon-Cor. in stream 70 lks.  
WIT: 10" W.Ash N58°W 53 lks.  
10" B.Ash West 64 lks.

19 G.D.Henning  
Mon-in river  
WIT: 1½" Pipe West 90.00'  
½" Bar East 377.26'  
½" Bar East 389.86'

B. Description of corner evidence found and/or method applied in restoring or reestablishing corner:

Position in river verified location by measurement to accessories of record.  
Accepted as the best available evidence of the position of the original corner.

C. Description of monument for corner and accessories established to perpetuate locating the position of the corner:

Mon- Position is in river, found the following reference corners and witness.

- 1½" pipe East 90.00 on section line.  
½" bar East 377.26 on Section line  
½" bar East 389.86 on section line.

Set nail & tag 4' above ground W. side 11" B. Oak N04°06'24"W 107.00  
Set Nail & tag SW side 20" B. Oak N54°40'34"W 98.43  
Set 6" Polebarn nail for traverse point N04°49'03"W 525.98  
Set 6" Polebarn nail for traverse point N88°02'20"W 93.94

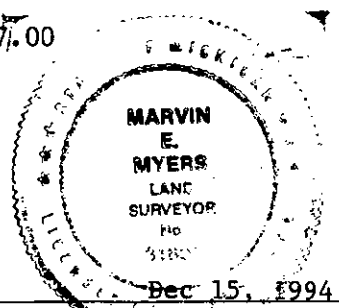

Signed by Marvin E. Myers  
Surveyor's Michigan License No. 31600

Date Dec 15, 1994