

FEB 22 1996

LIBER

2 PAGE 73

RECEIVED FOR RECORD

95 DEC -6 PH 2:49

COMMISSION

LAND CORNER RECORDATION CERTIFICATE

Filing Requirement of Act 74, Mich. P.A. 1970

For corners in

Sanilac

(County)

Located In:

Corner Code #

1. Public Land Survey

T10N R 16E

B - 5

D - 5

T R

T R

T R

2. Property Controlling in Section

S T R

S T R

3. Miscellaneous

S T R

Property in Sec.

S T R

4. Lot No. , Recorded Plat

5. Private Claims

I, John A Millettics, in a field survey on Oct 13, 1995, do hereby certify that under requirements of P.A. 74, Michigan P.A. of 1970, the corner points mentioned in lines 1 and 2 above were in conformance with regulations and rules therefore as required in the current manual of survey instructions of the United States Department of the Interior, Bureau of Land Management or by a decree of a Court of Law and/or that the corner points mentioned in lines 3, 4 and 5 above were in conformance with the rules of the Michigan Board of Land Surveyors or by a Decree of a Court of Law; established, re-established, monumented, re-monumented, recovered, found as expressed below:

NOTE: Not more than 4 corners, all in the same town and range, may be recorded on this certificate.

A. Description of original monument and accessories and/or subsequent restoration:

B - 5

GLO Notes

Set Post at 37.80 - 40.00

Maple 7 North 14

Cedar 9 S36W 19

Act 74 Liber 1 Page 271

Act 132 Liber 2 Page 340

Old Survey Liber Page 301

D - 5

GLO Notes

Set 1/4 Post at 40.34

B Ash 14 S26W 4

B Ash 17 N02W 48

Act 74 None

Act 132 None

Old Survey Liber None

B. Description of corner evidence found and/or method applied in restoring or reestablishing corner:

B - 5

S 1/4 Cor Section 7 T10N-R16E

Found 5/8" Iron Bar

D - 5

S 1/4 Cor Section 8 T10N-R16E

Found R/R Spike in Blacktop

Approved Peer Board Meeting

Dec 6, 1995

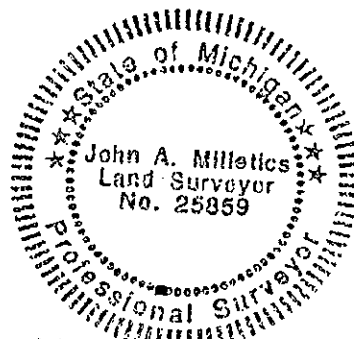

C. Description of monument for corner and accessories established to perpetuate locating the position of the corner:

B - 5

S 1/4 Cor Section 7 T10N-R16E

5/8" Iron Bar in gravel road bed

North 33.00 to a 1/2" Iron Bar

N45W 40.35 to a nail in a Multi Apple

S05W 25.27 to a nail in a Fence Post

S40E 30.6 to a nail in a 12" Ash

D - 5

S 1/4 Cor Section 8 T10N-R16E

Monu Box

South 2.1' to the centerline of Road

West 9.0' to the centerline of R/R Tracks

N50°W 76.0' to a nail in a Power Pole

N45°E 70.95 to a nail in a Power Pole

signed by

*John A. Millettics*

Date

Nov 23, 1995

Surveyor's Michigan License No.

25859