

SURVEY & REMONUMENTATION

FEB 08 2000

LAND CORNER RECORDATION CERTIFICATE Filing Requirement of Act 74, Mich. P.A. 1970

LIBER 5 PAGE 170

For corners in SECTION

St. Joseph
(County)

Located in:

Corner Code #

Fawn River Twp.
1. Public Land Survey

T 8S R 9W M-5

2. Property Controlling
in Section

S T R

3. Miscellaneous
Property in Sec.

S T R

4. Lot No. , Recorded Plat

5. Private Claims

I, Wayne A. Mostrom, in a field survey on MAY 5, 1999 do hereby state that under requirements of P.A. 74, Michigan P.A. of 1970, the corner points mentioned in lines 1 and 2 above were in conformance with regulations and rules therefore as required in the current manual of survey instructions of the United States Department of the Interior, Bureau of Land Management or by a decree of a Court of Law and/or that the corner points mentioned in lines 3, 4 and 5 above were in conformance with the rules of the Michigan Board of Land Surveyors or by a Decree of a Court of Law; established, re-established, monumented, recovered, found as expressed below:

NOTE: Not more than 2 corners, all in the same town and range, may be recorded on this certificate.

A. Description of original monument and accessories and/or subsequent restoration:

GLO

15" W.O. = N80°W 12½ (8.25')
15" W.O. = S39½°W 37 (24.42')

Boone 1971 Survey shows RR spike
@ SW cor. Sec. 17
RR spike = E. 330'
Nail = N. 132'

Sayers 1984 Survey & LCRC In 3/150 (1980)

RR spike found
33" Oak = SW 19.27'
18" Oak = SE 43.37'
Cor. post = NW 45.04'

Note: GLO data is unclear on log.

LCRC In 2/246 (1989)

RR spike
F.P. = N40°W 51.31'
SW Gar. cor. = N56°E 87.69'
18" Oak = S69°E 52.47'
F.P. = South 24.86'
Cor. Is 1' S. of rdwy.

Weaver 1988 Survey

Found RR spike
(Used for Sec. lines in
Sec. 13)

B. Description of corner evidence found and/or method applied in restoring or reestablishing corner:

Nothing physical found - Dug 36" deep at location
by Sayers & Mostrom witnesses & found nothing
RR spike found 329.79' of witness position (Hill)
Found nail 1" below asphalt 132' North
rdwy to N. = 2' West, witness point is in E-W rdwy

RATIFIED BY PEER GROUP
IN ACCORDANCE WITH P.A. 345
ON MAY 5, 1999
Wayne A. Mostrom CO. REPRESENTATIVE

C. Description of monument for corner and accessories established to perpetuate locating the position of the corner:

Set 5/8" x 24" bar w/std. cap in Mon. box
from several old witnesses still in place
N & W in East side 40" Oak = S20°W 19.27'
N & W in North side 32" Oak = S64°E 43.37'
N & W in SW side fence post = N40°W 51.31'
SW cor. garage fdtn. = N56°E 87.69'
N & W in West side fence post = South 24.86'

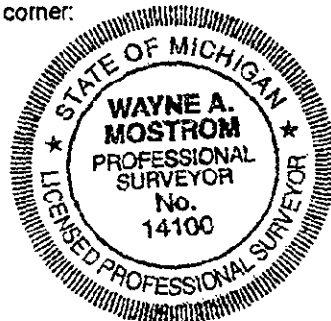

LIBER 5 PAGE 170

Signed by Wayne A. Mostrom
Surveyor's Michigan License No. 14100

Date 5/11/99

REMONUMENTATION