

SCHOOLCRAFT COUNTY  
PEER GROUP APPROVED

DATE 12/15/99 JPB LAND CORNER RECORDATION CERTIFICATE  
Filing Requirement of Act 74, Mich. P.A. 1970

For corners in

Schoolcraft

(County)

Located In:

Corner Code #

1. Public Land Survey

T41N R14W

K3

T R

T R

T R

T R

T R

T R

T R

T R

T R

T R

T R

T R

T R

T R

T R

T R

T R

T R

T R

T R

T R

T R

T R

T R

T R

T R

T R

T R

T R

T R

T R

T R

T R

T R

T R

T R

T R

T R

T R

T R

T R

T R

T R

T R

T R

T R

T R

T R

T R

T R

T R

T R

T R

T R

T R

T R

T R

T R

T R

T R

T R

T R

T R

SIGRID HEDBERG

SCHOOLCRAFT CO. REGISTER

1P

Page 1 of 1

LC 4/338

JLO Date 12/30/1999

Time 13:59:18

RECORDING FEES:

9.00

SECTION

Register of Deeds Stamp & File Number

4. Lot No. , Recorded Plat  
5. Private Claims

I, Thomas P. O'Brien, in a field survey on 12/18, 1999 do hereby state that under requirements of P.A. 74, Michigan P.A. of 1970, the corner points mentioned in lines 1 and 2 above were in conformance with regulations and rules therefore as required in the current manual of survey instructions of the United States Department of the Interior, Bureau of Land Management or by a decree of a Court of Law and/or that the corner points mentioned in lines 3, 4 and 5 above were in conformance with the rules of the Michigan Board of Land Surveyors or by a Decree of a Court of Law; established, re-established, monumented, recovered, found as expressed below:

NOTE: Not more than 2 corners, all in the same town and range, may be recorded on this certificate.

	A	B	C	D	E	F	G	H	I	J	K	L	M
1													
2		6		5		4		3		2		1	
3													
4		7		8		9		10		11		12	
5													
6		18		17		16		15		14		13	
7													
8		19		20		21		22		23		24	
9													
10		30		29		28		27		26		25	
11													
12		31		32		33		34		35		36	
13													

A. Description of original monument and accessories and/or subsequent restoration:

Sept. 5, 1845 J. Burt, DS set post corner of Sections 1, 2, 11 & 12

Y. Pine 6 N33½E 16 Do 5 S54W 16

April 8, 1976 Thomas P. O'Brien, PS "Found pipe - blazed line to North and 8" Jack Pine witness. Pipe ½".

1979 Schoolcraft County surveyor reset pipe with Schoolcraft County monument stamped to identify.

B. Description of corner evidence found and/or method applied in restoring or reestablishing corner:

Dec. 18, 1999 Thomas P. O'Brien, PS found Schoolcraft County monument. Existing witnesses verify corner position.

C. Description of monument for corner and accessories established to perpetuate locating the position of the corner:

Schoolcraft County monument

Witnesses:

10" Jack Pine N17°E 9.7'

12" White Pine S3°E 7.1'

12" Jack Pine S70°E 15.4'

6" Jack Pine N37°W 18.87'

Carsonite Post North 1.0'

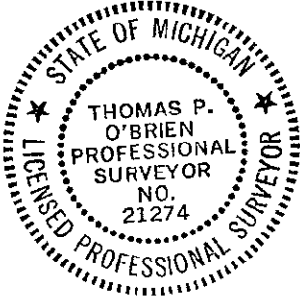

Signed by Thomas P. O'Brien

Date Dec. 22, 1999

Surveyor's Michigan License No. 21274