

SURVEY & REMONUMENTATION

DEC 15 1993

COMMISSION

LAND CORNER RECORDATION CERTIFICATE  
Filing Requirement of Act 74, Mich. P.A. 1970  
REMONUMENTATION

RECORDED

93 DEC -6 AM 10:59

REGISTER OF DEEDS

SHIAWASSEE COUNTY, MICH.

Register of Deeds Stamp & File Number

	A	B	C	D	E	F	G	H	I	J	K	L	M
2	6		5		4		3		2		1		
3													
4	7		8		9		10		11		12		
5													
6	18		17		16		15		14		13		
7													
8	19		20		21		22		23		24		
9													
10	30		29		28		27		26		25		
11													
12	31		32		33		34		35		36		
13													

Norman C. Caldwell, in a field survey on November, 19 93, do hereby certify that under requirements of P.A. 74, Michigan P.A. of 1970, the corner points mentioned in lines 1 and 2 above were in conformance with regulations and rules therefore as required in the current manual of survey instructions of the United States Department of the Interior, Bureau of Land Management or by a decree of a Court of Law and/or that the corner points mentioned in lines 3, 4 and 5 above were in conformance with the rules of the Michigan Board of Land Surveyors or by a Decree of a Court of Law; established, re-established, monumented, re-monumented, recovered, found as expressed below:

NOTE: Not more than 4 corners, all in the same town and range, may be recorded on this certificate.

A. Description of original monument and accessories and/or subsequent restoration:

K-13 Sec. cor., 35 & 36, T5N-R1E

Wood post placed by J. Wampler, 1826  
N06°E 25 lks. (16.5') 14" W. Oak  
N45 1/2°W 122 lks. (80.52') 9" W. Oak

Surveys by L. J. Hendryx, July 1972,  
recorded in L. 1, pg. 58 of Corners &  
L. 1, pgs. 100-103 of Surveys  
Gas Pipe  
SSE 21.8' Center 12" Pignut  
SW 27.9' Center 20" Oak  
WSW 43.8' Center 30" Oak  
SE 29.7' Center 10" Pignut

Survey by R. M. Lester, Dec. 1973 recorded  
in L. 1 pg. 172 of Corners & L. 1, pg. 578 & 579  
of Surveys  
Fnd. 1/2" gas pipe, measured dist. North in close  
accord. with original government meas.  
SE 38.57' N & T W. side 14" Hickory  
South 21.65' N & T W. side 12" Hickory  
SW 43.00' N & T E. side 24" Oak

Survey by L. J. Hendryx, May 1976, recorded in  
L. 2, pg. 351 of Surveys  
Fnd. gas pipe  
No refs. given

Survey by M. R. Dyer, Sept. 1980, recorded in L. 3,  
pgs. 477 & 478 of Surveys  
Monument not given  
SE 38.57' N & T W. side 14" Hickory  
South 21.65' N & T W. side 12" Hickory  
SW 43.00' N & T E. side 24" Oak

B. Description of corner evidence found and/or method applied in restoring or reestablishing corner:

K-13 Sec. cor., 35 & 36, T5N-R1E

Fnd. 1/2" rerod over the record gas pipe per L. 1, pg. 58 & L.1 pg.  
172 of Corners & L. 1, pg.s 100 - 103 & 578 - 579, L. 2, pg. 351 &  
L. 3, pgs. 477 & 478 of Surveys. Replaced with a standard 20"  
Harrison marker as approved by the Shiawassee County Peer Review  
Group, placed a mon. box, and is accepted as the best available  
evidence of the position of the orig. cor.

C. Description of monument for corner and accessories established to perpetuate locating the position of corner:

K-13 Sec. cor., 35 & 36, T5N-R1E

Fnd. 1/2" rerod over the record gas pipe per L. 1, pg. 58 & L.1 pg.  
172 of Corners & L. 1, pg.s 100 - 103 & 578 - 579, L. 2, pg. 351 &  
L. 3, pgs. 477 & 478 of Surveys. Replaced with a standard 20"  
Harrison marker as approved by Shiawassee County Peer Review Group,  
placed a mon. box, and is accepted as the best available evidence of  
the position of the orig. cor.  
East 147.78' Fnd. bar & cap (unreadable) in mon. box at K-1, T4N-R1E (R)  
S10°E 21.79' Fnd. N & T #18998 in W. face 12" Pignut Hickory (R)  
S45°E 38.59' Fnd. N & T #18998 in W. face 15" Pignut Hickory (R)  
S60°W 42.89' Set N & T #12018 NW face 30" Oak (Rec. tree)  
S45°W 27.92' Set N & T #12018 in NW face 32" Oak

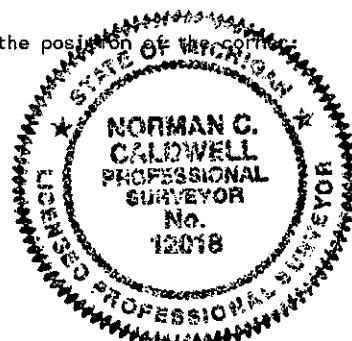

Signed by [Signature] Date 20 NOV 93

Surveyor's Michigan License No. 12018