

MAY 05 1997

COMMISSION

1996 REMONUMENTATION PROGRAM

LAND CORNER RECORDATION CERTIFICATE
Filing Requirement of Act 74, Mich. P.A. 1970

For corners in Juniata Township

TUSCOLA

(County)

Located in:

Corner Code #

1. Public Land Survey

T 12NR 8E

Λ-9

T R

T/2N R 7E

T____R____

2. Property Controlling in Section

22

T	R
T	R

3. Miscellaneous Property in Sec

§
§

T	R
T	R

4. Lot No. _____, Recorded Plat _____

5. Private Claims

I, Kenneth D. Dunton, in a field survey on Oct. 15, 1995 do hereby state that under requirements of P.A. 74, Michigan P.A. of 1970, the corner points mentioned in lines 1 and 2 above were in conformance with regulations and rules therefore as required in the current manual of survey instructions of the United States Department of the Interior, Bureau of Land Management or by a decree of a Court of Law and /or that the corner points mentioned in lines 3, 4 and 5 above were in conformance with the rules of the Michigan Board of Land Surveyors or by a Decree of a Court of Law; established, re-established, monumented, recovered, found as expressed below:

NOTE: Not more than 2 corners, all in the same town and range, may be recorded on this certificate.

[illegible]

A. Description of original monument and accessories and/or subsequent restoration:

1834 G.L.O. Notes
Orange Risdon, D.S.
Set Post Corner of
Section 24 & 25

June 18, 1974 Act 74 form filed by David T. Rowe, L.S. #11192
recorded on Page 4 Juniata Twp., Tuscola County Records. Fnd.
1 1/2" pipe N60°E 43.40' face of road sign post, S35°E 50.80'
R.L.S. #11192 tag in p.p., S50°W 63.25' R.L.S. #11192 tag in p.p.

Beech 10 S55W 14L
Beech 8 N68W 47L
Corner M-9, T12N-R7E

April 18, 1975 Act 74 form filed by John W. Martin, L.S. #4699
recorded on Page 30 Denmark Township, Tuscola County Records.
2" pipe. N.E. 36.15' to ctr. st. sign post. S.E. 50.85'
to nail & cap in W. face p. pole. S.W. 63.25' to nail
& cap in E. face p. pole.

B. Description of corner evidence found and/or method applied in restoring or reestablishing corner:

Found 2" pipe in place. Accepted pipe as the proper location of Corner A-9.

C. Description of monument for corner and accessories established to perpetuate locating the position of the corner:

Removed 2" pipe & placed concrete monument with standard brass cap stamped Corner M-9, T12N-R7E. Placed monument box over monument. Set 11-19-95.

S52°10'W 63.25' fnd. #11192 tag & nail in NE face p. pole.

S36°43'E 50.84' find. #11192 tag & nail in NW face p. pole.

N43°05'W 31.75' set 1/2" x 18" re-rod in shoulder of road.

N45°13'E 33.71' set 1/2" x 18" re-rod in shoulder of road.

Note: This corner is common with M-9, T12N-R7E.

Signed by

Surveyor's Michigan License No. 23503

Date _____

APPROVED

10-23-96

FORM APPROVED BY MICHIGAN STATE BOARD OF PROFESSIONAL SURVEYORS, JAN. 20, 1971
 REVISED MAY 14, 1975
 REVISED JAN. 1983
 REVISED OCT. 1985

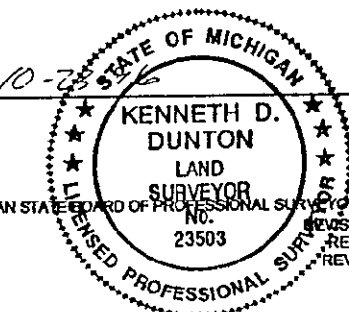

COPY

Section A continued:

Sept. 6, 1980 Survey by Kenneth D. Dunton, R.L.S. #23503, recorded in Liber 509, Page 1329.
Found 1 1/2" pipe. Same accessories as Act 74, Page 4, Juniata Township.

Oct. 29, 1981 Survey by Ronald C. Prevost, L.S. #24612 recorded in Liber 520 Page 1414, Tuscola
County Records. Same accessories as Act 74, Page 4, Juniata Township.

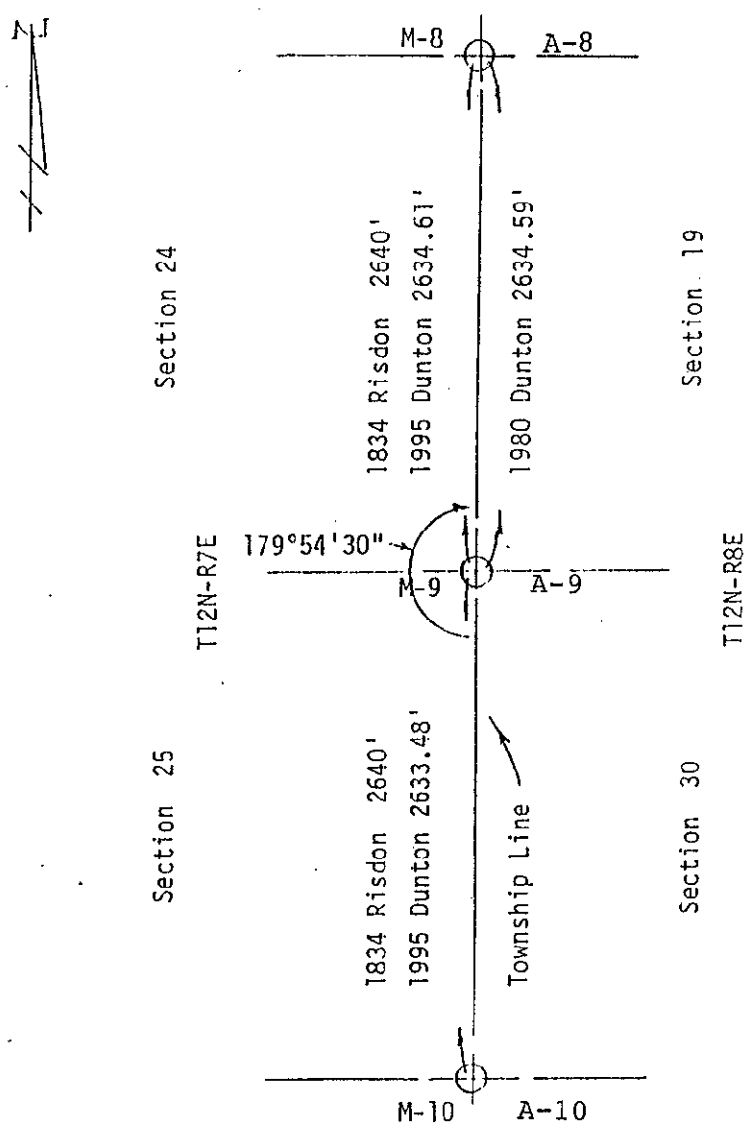

COPY