

FILED

Dec 1 9 28 AM '99

LAND CORNER RECORDATION CERTIFICATE

FILING REQUIREMENTS OF ACT 74, MICH. P.A. 1970

S 1/4 Post, Section 23 South Haven Twp.

FOR CORNERS OF:

LOCATED IN:

CORNER CODE NUMBER

1. PUBLIC LAND SURVEY

T. 1 S. R. 17 W.

J-9

2. PROPERTY CONTROLLING IN SECTION

T. S. R. W.

3. MISCELLANEOUS PROPERTY IN SECTION

T. S. R. W.

4. LOT NO. RECORDED PLAT

5. PRIVATE CLAIMS

DEC 28 1999

SECTION

REGISTER OF DEEDS STAMP
AND FILING NUMBER9-00
B190 12/01 0104 10SURVEY

I, Charles D. Lossie, P.S., in a field survey on 11-Nov, 19 99 do hereby state that under requirements of P.A. 74, Michigan P.A. of 1970, the corner points mentioned in lines 1 and 2 above were in conformance with regulations and rules therefore as required in the current manual of survey instructions of the United States Department of the Interior, Bureau of Land Management or by a decree of a Court of Law and/or that the corner points mentioned in lines 3, 4 and 5 above were in conformance with the rules of the Michigan Board of Land Surveyors or by a Decree of a Court of Law; established, re-established, monumented, recovered, found as expressed below:

NOTE: Not More than 2 corners, all in the same town and range may be recorded on this certificate.

	A	B	C	D	E	F	G	H	I	J	K	L	M
1													
2		6	5		4		3		2		1		
3													
4		7	8		9		10		11		12		
5													
6		10	11		12		13		14		15		
7													
8		13	14		15		16		17		18		
9													
10		16	17		18		19		20		21		
11													
12		19	20		21		22		23		24		
13													

A. Description of original monument and accessories and/or subsequent restoration:

3/1830 - GOVERNMENT - R. Clark, Jr., D.S.

Corrected West a distance of 40.135 chs. (2648.91') and set Quarter Section Post

Witnesses: 6" Hemlock - North - 2 lks. (1.32').

13" Beech - S. 9° E., - 13 lks. (8.58').

Ratified by Peer Group in
accordance with P.A. 345 of 1990
Van Buren County Surveyor

See Back for Additional Corner History

Date 12-1-99 S. R. A.

B. Description of corner evidence found and/or method applied in restoring or re-establishing corner:

Found 3/4" pipe in Monument Box. Dug down 30", found 2 stones and pipe with rail road spike, set in the pipe. The position of this Government Monument was accepted and restored with the approval of the Van Buren County Remonumentation Peer Group of Surveyor's on June 30, 1999 as the best available evidence of the original corner.

C. Description of monument for corner and accessories established to perpetuate locating the position of the corner:

Set slim line Harrison Marker in Monument Box at the position of the pipe with rail road spike set in the pipe.

Power Pole - N. 40° W., 45.59' to PK. And Washer.

10" Spruce - N. 45° E., 85.70 to PK. And Washer.

Guy Pole - S. 40° E., 47.55' to PK. And Washer

1/2" iron rebar 1.70' East of dead end street sign, S. 01° W., 65.52'.

Signed by

Charles D. Lossie P.S.
Charles D. Lossie, P.S.

Surveyor's Michigan License No.

44291

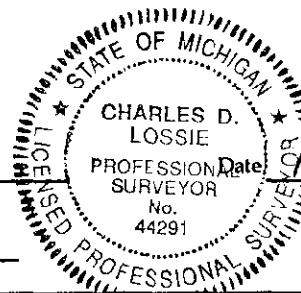

FORM APPROVED BY MICHIGAN STATE BOARD OF PROFESSIONAL SURVEYORS,

JAN. 28, 1971

REVISED May 14, 1975

REVISED JAN., 1983

REVISED OCT., 1996

Sheet 5 pg. 229

South 1/4 Post Section 23, South Haven Twp. (J-9)

12/29/1902 - W. H. Goss, C.S.

Section 23

Red Book & Goss Notes

Stones

Witnesses:

White Oak - S. 11° W., - 42.5 lks. (28.05')

Newer- Hickory or 8" Ash - SE. - 79 lks. (52.14').

4/20/1903 - Book 1 - Page 138

Found stones - Oak witness is the same as above.

Distance West is 20.02 chs. (1321.32').

Distance North is 19.855 chs. (1310.93') and continuing North 1310.43' to Center Quarter Post for a total of 2620.86'.

Drain Notes - Drain Office.

McLain Drain starts at a point 11.30 chs. (745.80') North and 9 chs. (594.00') West of the South Quarter Post.

2/23/1944 - T. A. Smith, C.S.

Section 23

Found stones and railroad spike - drove pipe and put railroad spike in top.

Witnesses:

12" Catalpa - N. 35° W., - 32.5' to Centerline.

15" Ash - N. 12° E., - 96.00' to Centerline.

5/15/1975 - G. J. Mitchell, R.L.S.

Recordation Certificate (Liber 2 - Page 451).

Found 1" pipe.

Witnesses:

Power Pole - NW. - 47.38'.

Power Pole - E. NE., - 123.53'.

Light Anchor Pole - SE., 47.65'.

11/1/1996 - Drawing shows:

Found 1" pipe in monument box.

Witnesses:

Power Pole - N. 45° W., 47.70'.

Power Pole - S. 45° E., 47.47'.

Maple (face) - S. 40° E., 75.55'.

Hickory - S. 55° E., 90.40'.

Distance East is 1230.33' to Eighth Post.

Distance North is 655.60' and continuing North 655.60' for a total of 1311.20'.

DEC 28 1999

SECTION