

LAND CORNER RECORDATION CERTIFICATE
Filing Requirement of Act 74, Mich. P.A. 1970

LIBER 28482 PAGE 684

For corners in

WAYNE
(County)

Located in:
LINCOLN PARK

Corner Code #

1. Public Land Survey

T 3 S R 11 E #004

T R

T R

T R

2. Property controlling
in Section

S T R

S T R

3. Miscellaneous
Property in Sec.

S T R

S T R

SECTION

4. Lot No. Recorded Plot

5. Private Claims WEST LINE PRIVATE CLAIM No. 671

Compliance with
ACT 345, P.A. 1990

APPROVED ON: 12-13-95
WAYNE COUNTY REMONUMENTATION
PEER GROUP COMMITTEE

Register of Deeds Stamp & File Number

I, PAUL V. SCHWIMMER, in a field survey on NOVEMBER 16, 19 95, do hereby certify that under requirements of P.A. 74, Michigan P.A. of 1970, the corner points mentioned in lines 1 and 2 above were in conformance with regulations and rules therefore as required in the current manual of survey instructions of the United States Department of the Interior, Bureau of Land Management or by decree of a Court of Law and/or that the corner points mentioned in lines 3, 4 and 5 above were in conformance with the rules of the Michigan Board of Land Surveyors or by Decree of a Court of Law; established, re-established, monumented, re-monumented, recovered, found as expressed below:

NOTE: Not more than 4 corners, all in the same town and range, may be recorded on this certificate

A. Description of original monument and accessories and/or subsequent restoration:

NO ORIGINAL MONUMENT WAS PERVIOUSLY SET AT THIS LOCATION

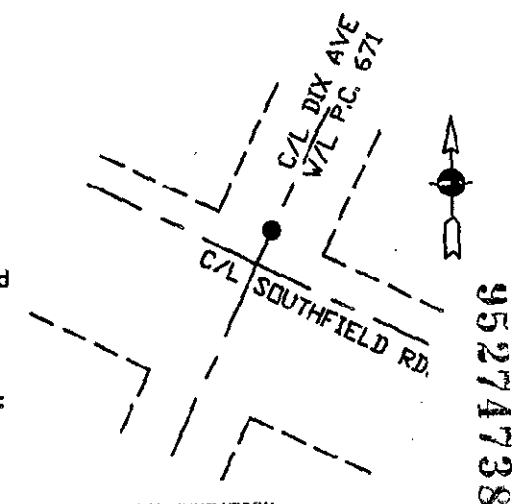

\$ 4.00 REMONUMENTATION

\$ 7.00 DEED

26 DEC 95 3:22 P.M. RECEIVED

RECORDED

FOREST E. YOUNGBLOOD, REGISTER
WAYNE COUNTY, MI

B. Description of corner evidence and/or method applied in restoring or reestablishing corner:

THE POSITION OF THIS MONUMENT WAS ESTABLISHED BY THE RECONSTRUCTION OF EXISTING FOUND CONTROL AND PLACED ON THE WEST LINE OF PRIVATE CLAIM 671 NEAR THE NORTHERLY RIGHT OF WAY OF SOUTHFIELD ROAD. THE LOCATION OF THE NORTHERLY RIGHT OF WAY OF SOUTHFIELD ROAD WAS BASED ON THE PLAT OF "LINCOLN PARK MANOR No. 1" RECORDED IN LIBER 45 OF PLATS, PAGE 79, WAYNE COUNTY RECORDS, WAYNE COUNTY, MICHIGAN

C. Description of monument for corner and accessories established to perpetuate locating the position of the corner:

SET 1/2" IRON IN MONUMENT BOX ON THE WEST LINE OF PRIVATE CLAIM No. 671

N 90° E 27.20' CENTER OF MANHOLE
S 85° W 47.65' FD. UTIL POLE WITH TAG
S 40° E 47.60' CENTER OF MANHOLE
S 50° E 48.70' CENTER OF MANHOLE
S 65° E 40.05' CENTER OF UNDERGROUND UTIL. BOX
S 65° E 38.55' CENTER OF UNDERGROUND UTIL. BOX

PLACED WAYNE CO.
REMONUMENTATION DISK
AND CAP ON IRON.

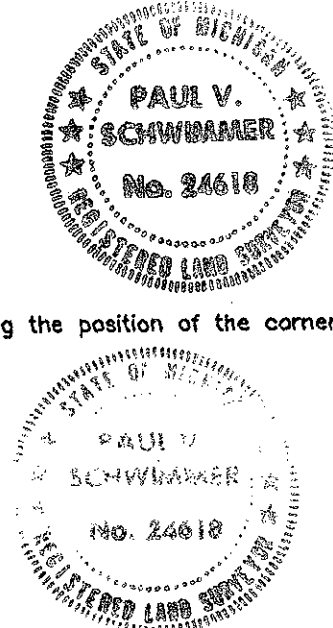

THE SELECTED LOCATION IS ACCEPTED BY THE CONTRACTOR AND IS GENERALLY ACCEPTED BY PROFESSIONAL SURVEYORS AS THE BEST AVAILABLE EVIDENCE FOR A POSITION ON THE WEST LINE OF PRIVATE CLAIM No. 671

Signed by Paul V. Schwimmer

Date 12-12-95

Surveyor's Michigan License No. 24618

4R
70
77