

SURVEY & REMONUMENTATION

MAY 31 2000

DEED LIBER 2564 PAGE 547

LAND CORNER RECORDATION CERTIFICATE

Filing Requirement of Act 74, Mich. P.A. 1970

SECTION

For corners in
Genesee
(County)

Located In: Corner Code #

- 1. Public Land Survey T 7N R 8E M-2
T R
T R
T R
- 2. Property Controlling S T R
in Section S T R
- 3. Miscellaneous S T R
Property in Sec. S T R
- 4. Lot No. _____ Recorded Plat _____
- 5. Private Claims _____

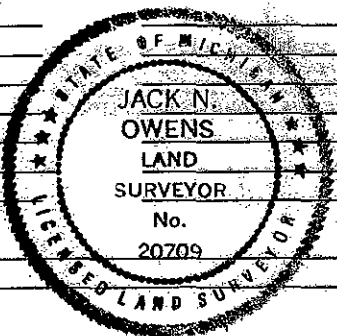

RECORDED
REGISTER OF DEEDS
FEB 10 17 AM '95
GENESEE COUNTY
REGISTER OF DEEDS
5493
Register of Deeds Stamp & File Number 11-1

	A	B	C	D	E	F	G	H	I	J	K	L	M
1													
2	6	5	4	3	2								
3													
4	7	8	9	10	11	12							
5													
6	18	17	16	15	14	13							
7													
8	19	20	21	22	23	24							
9													
10	30	29	28	27	26	25							
11													
12	31	32	33	34	35	36							
13													

I, Jack N. Owens, in a field survey on DEC. 9 19 94, do hereby certify that under requirements of P.A. 74, Michigan P.A. of 1970, the corner points mentioned in lines 1 and 2 above were in conformance with regulations and rules therefore as required in the current manual of survey instructions of the United States Department of the Interior, Bureau of Land Management or by a decree of a Court of Law and/or that the corner points mentioned in lines 3, 4 and 5 above were in conformance with the rules of the Michigan Board of Land Surveyors or by a Decree of a Court of Law, established, re-established, monumented, re-monumented, recovered, found as expressed below:

NOTE: Not more than 4 corners, all in the same town and range, may be recorded on this certificate.

A. Description of original monument and accessories and/or subsequent restoration:
1821, GLO-J WAMPLER, DS GLO NOTES STATE THAT MEASURING NORTH FROM M-3 AT "40.00 CHS. 1/4 COR. FELL IN LAKE" THUS THE DEP. SUR. GIVES A POSITION FOR THE COR BUT FOLLOWS THAT WITH BRIEF NOTES ON AN OFFSET TRAVERSE AROUND LAKE. HE ALSO NOTES DISTANCES TO S. & N. SHORES OF LAKE (POTTER LAKE) WHICH DON'T FOLLOW HIS TRAVERSE INDICATING HE MADE THE MEASUREMENTS SEPARATE FROM HIS TRAVERSE.
NOTE: 1929/31, I.M.A. RECS D BINGHAM, PE - SURVEY OF IMA PROPERTY. NOT IDENTIFY MONUMENTATION BUT SHOWS SEC. LINE & DISTANCE FROM M-1 TO M-3. SEC. LINE WAS RETRACED AS STRAIGHT LINE. HE DID NOT SHOW POSITION FOR THIS COR. ON HIS SURVEY PROBABLY SINCE I.M.A. OWNED ENTIRE LENGTH OF MILE.

B. Description of corner evidence found and/or method applied in restoring or reestablishing corner:
I RETRACED THE E. LINE OF SEC. 1 AND FOUND BINGHAM ALSO HAD MONUMENTED IT AS A STRAIGHT LINE AS INTENDED BY THE GLO. SEE CERT. SUR. (ACT 132, L. 2561, P. 62-65) WITH PLAT REPRODUCED ON BACK OF THIS L.C.R.C. OTHER LINES RUN BY WAMPLER THAT CROSS LAKES ALONG E. COUNTY LINE ARE VERY CLOSE (WITHIN 2 TO 3 FT.) TO A STRAIGHT LINE SHOWING SUCH LINES COULD BE RUN STRAIGHT 110 OR MORE YEARS AGO. BINGHAM'S SURVEY SHOWED THE FENCE WAS 25-36 FT. W. OF ST. LINE. WE RECOVERED IRONS ON PENINSULA NEARLY ON LINE AS HE INTENDED & HIS DISTANCE IS VIRTUALLY IDENTICAL TO OUR RETRACEMENT. THE FENCE N. OF LAKE IS AT LEAST 80-90 YRS. OLD PER LAYPER CO. OWNER ANITA LAWSON, DATING TO HER GRANDPARENTS. IF FENCE IS PROJECTED S'LY TO M-3 IT WOULD BE 66-71 FT. W. NEVER COMING BACK TO LINE SINCE FENCE ON PENINSULA S. OF MID-POINT. HAD FENCE RESULTED FROM A RETRACEMENT SURVEY WOULD BE ANGLING BACK TO LINE, NO OTHER RECORDS, CO. SURVEYOR IN EITHER CO. OR OTHERWISE WERE FOUND IN RESEARCH. DO NOT CONSIDER FENCE REPRESENTING GLO TWP. LINE. I CONCLUDE TO RETRACE ST. LINE FROM M-1 TO M-3 AS GLO INTENDED. NO EVIDENCE GLO MONUMENTED LINE AT SHORES OF LAKE & CONCLUDE GLO TRAVERSE AROUND LAKE MISMEASURED MILE. WILL SET TWO POINTS BE MONUMENTED AS WITNESS CORNERS TO REFERENCE THE POSITION OF 1/4 COR., NOT MONUMENTED BUT NOTED IN GLO RECORD, THAT ALLOW RETRACEMENTS OF LINE WITHOUT TRAVERSING ENTIRE MILE AND ALSO FIX COUNTY BOUNDARY.

RATIFIED BY GEN. CO. PEER GROUP DEC. 7, 1994.

C. Description of monument for corner and accessories established to perpetuate locating the position of the corner:
N'LY WIT. COR. 30" N. OF SHORELINE AT 688.04' N. OF E 1/4 COR.
NORTH 32.43' SET 40D/GCREMON TAG E. FC. 16" NORWAY SPRUCE
N69E, 36.15' SET 40D/GCREMON TAG N. FC. 18" RED MAPLE
S09W, 26.84' SET 40D/GCREMON TAG W. FC. 10" RED MAPLE
S63°56'30"W, 26.12' FND 1/2" REROD IN OLD N-S FNC.
N56W, 29.25' SET 40D/GCREMON TAG SW. FC. 12" FORKED BLK CHERRY
S'LY WIT COR. IN THIN SMALL GROVE TREES N. SIDE OF PENINSULA AT 274.89' S. OF E 1/4 COR.
N01E, 21.07' SET 40D/GCREMON TAG E. FC. 16" RED MAPLE
S79E, 11.63' SET 40D/GCREMON TAG S. FC. 18" RED MAPLE
S16W, 26.93' SET 40D/GCREMON TAG W. FC. 16" WHITE ASH
N61W, 13.94' SET 40D/GCREMON TAG N. FC. 14" RED MAPLE
S00°12'14"W, 175.04' SET 1/2" REROD CAP-20709 ON LINE 1-1/2' N/S SHORE
N00°19'35"W 39.00' FND 1" PIPE (1929 SURVEY)
I SET THE STANDARD BERNSTEN MONUMENT SS-A-5-BR-30(3 1/4" D. BRASS CAP STAMPED "GENESEE COUNTY REMONUMENTATION CORNER, WIT COR., 20709, 1994" WITH 30" X 2 3/8" O.D. STAINLESS STEEL TUBE) FOR BOTH WIT. CORNERS ON SHORELINE OF POTTER LAKE FLUSH WITH GROUND ON E. LINE OF SEC.

Signed by Jack N. Owens Date Dec 30, 1994
Surveyor's Michigan License No. 20709

FORM APPROVED BY MICHIGAN STATE BOARD OF LAND SURVEYORS, JAN. 22, 1971
REVISED MAY 14, 1976
REVISED JAN., 1983
ADAPTED FOR WORD PROCESSING MARCH, 1993

Ratified by Peer Group in accordance with P.A. 345, 1990

Co. Rep. Carl Carlson
Date 12-7-94



89

EAST LINE OF SECTION 1
T7N-R8E, DAVISON TWP.

DEED LIBER 2564 PAGE 548



SCALE: 1" = 500'
DATE: NOV. 9, 1994
REV: NOV 16, 1994
REV: DEC 13, 1994

GENESEE COUNTY
REMONUMENTATION
DAVISON TWP.

NORTH 1/4 CORNER
SECTION 1 (L-1)
T7N-R8E

NORTHEAST CORNER
SECTION 1 (M-1)
T7N-R8E

OLD LINE OF OCCUPATION, NOTED IN 1929, STILL EXISTS. OLD FENCE STARTS AT 170' +/- SOUTH OF NE CORNER AND RUNS APPROX. S 00°56' W. (NO EVIDENCE THIS FENCE WAS BASED UPON A SURVEY.)

RECORDED
REGISTER OF DEEDS
DEC 28 3 31 PM '94
GENESEE COUNTY
REGISTER OF DEEDS

GENESEE COUNTY
DAVISON TWP.

FENCE OCCUPATION IS 23.8' W

FND 1/2" REROD. (NO CAP)
23.43' W & 11.56' S (IN FENCE)

SET WITNESS CORNER
POINT 3288.67' NORTH
OF SE CORNER

MID-POINT (IN LAKE)
(POSITION FOR 1/4 COR. M-2,
BUT NOT SET IN G.L.O. SURVEY)

FND 1" I.D. PIPE (1929)
0.36' W OF STRAIGHT LINE
2364.74' N OF SE CORNER.

LAPEER COUNTY
ELBA TWP.

INTERIOR 1/4 CORNER
SECTION 1 (L-2)
T7N-R8E

SET WITNESS CORNER
2354.74' NORTH OF
SE CORNER.

OLD 1929 FENCE (NOW
GONE) WAS 39' TO 45' WEST
OF LINE ON PENINSULA.

SET REFERENCE POINT
2149.90' N OF SE CORNER
(1/2" REROD / CAP 20709)

EAST LINE OF SECTION 1 AND COUNTY LINE.
(STRAIGHT LINE BETWEEN CORNERS M-1 &
M-3. USED BY DON BINGHAM IN 1929 SURVEY
OF I.M.A. PROPERTY AND IN ACCORDANCE WITH
G.L.O. RECORDS. NO OTHER RECORDS, COUNTY
SURVEYOR IN EITHER COUNTY, OR OTHERWISE,
WERE FOUND IN RESEARCH.)

FND 1/2" I.D. PIPE (1929)
1.13' W OF STRAIGHT LINE
2139.90' N OF SE CORNER.

SURVEY &
REMONUMENTATION

SHORE LINE IS GRAPHICALLY
SHOWN FROM AERIAL PHOTO.

MAY 31 2000

SECTION

SOUTH 1/4 CORNER
SECTION 1 (L-3)
T7N-R8E

90°45'R (1929)
90°45'01"M (1994)

NOTE: FENCE PROJECTED
SOUTH TO M-3 WOULD BE
AT LEAST 66' - 71' WEST

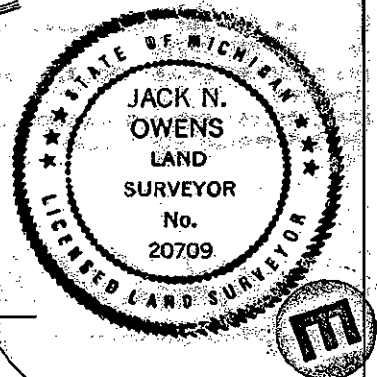

S 89°27'13" W 2672.25' (40.489 CH) M
2672.5' (40.492 CH) M.D.O.T. 1940
2670.1' (40.456 CH) M.D.O.T. 1928
2672.65' (40.495 CH) G.C.R.C. 1916 / 1925
(2683') 40.645 CH G.L.O. 1822

73965

SOUTHEAST CORNER
SECTION 1 (M-3)
T7N-R8E

Jack A. Owens
SHEET 1 of 4

ROWE ENGINEERING INC.

FLUSHING CORUNNA CARO MT. PLEASANT
1449 E. Pierson 112 E. McArthur 166 N. State 127 S. Main
1500 810-659-3103 517-743-6363 517-673-2636 517-772-2138