

DEC 16 1996

COMMISSION

LAND CORNER RECORDATION CERTIFICATE
Filing Requirement of Act 74, Mich. P.A. 1970

Liber

9 Page 135

FILED

960046041
12/03/1996 13:23:03
REGISTER OF DEEDS
Paula Johnson
INGHAM COUNTY, MI

For corners in
INGHAM

LOCKE TOWNSHIP

Located In:

Corner Code ##

1. Public Land Survey	T	4N	R	2E	C-1
	T		R		
	T		R		
	T		R		
2. Property Controlling in Section	S		T	R	
	S		T	R	
3. Miscellaneous Property in Sec.	S		T	R	
	S		T	R	

Register of Deeds Stamp & File Number

4. Lot No. _____, Recorded Plat _____
5. Private Claims _____

I, RONALD L. ENGER, in a field survey on SEPTEMBER 27, 1995, do hereby certify that under requirements of P.A. 74, Michigan P.A. of 1970, the corner points mentioned in lines 1 and 2 above were in conformance with regulations and rules therefore as required in the current manual of survey instructions of the United States Department of the Interior, Bureau of Land Management or by a decree of a Court of Law and/or that the corner points mentioned in lines 3, 4 and 5 above were in conformance with the rules of the Michigan Board of Land Surveyors or by a Decree of a Court of Law; established, re-established, monumented, re-monumented, recovered, found as expressed below:

NOTE: Not more than 4 corners, all in the same town and range, may be recorded on this certificate.

A. Description of original monument and accessories and/or subsequent restoration:

1. POST SET IN ORIGINAL GOVERNMENT SURVEY BY J. WAMPLER, DEPUTY SURVEYOR IN MARCH 1826 WITH THE FOLLOWING NOTATION:
AT 96.46 CHAINS (3726.36') INTERSECTED NORTH BOUNDARY 150 LKS (99.0') EAST OF POST ELM 11" N66W 37
ELM 4" S52E 25

CONTINUED ON BACK.

B. Description of corner evidence found and/or method applied in restoring or reestablishing corner:

SEARCHED AT APPARENT LOCATION OF CORNER AND FOUND 3/4" BAR & CAP LS 28409 IN EAST-WEST FENCE LINE. ACCEPTED 3/4" BAR AS POSITION OF CORNER BECAUSE OF AGREEMENT WITH HISTORICAL OCCUPATION AND EXCELLENT PROPORTIONAL MEASUREMENT TO TJ BROWNS SURVEY OF SEPTEMBER 1864. BROWNS MEASUREMENT WAS 2584.46' TO D-1. CHANGED CAP TO PA345 PS 28409. MEASURED EAST 2595.39' TO D-1. MEASURED SOUTH 3753.02' TO C-2. MEASUREMENTS BASED ON M. FOUTY'S TRAVERSE IN REMONUMENTATION FIELD BOOK LO-1 AND ENGER SURVEYING TRAVERSE FOR JOB #33-282.

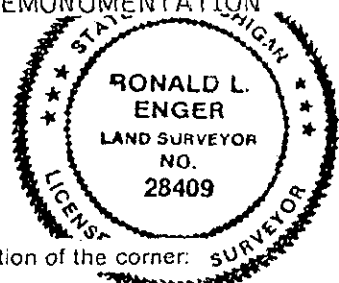

C. Description of monument for corner and accessories established to perpetuate locating the position of the corner:

C-1 T4N R2E
3/4" DIAMETER X 24" LONG SMOOTH STEEL BAR AND CAP IMPRINTED "PA 345 PS 28409"
5/8" REBAR AND CAP #28409 (C-13 PERRY TOWNSHIP), WEST, 99.00'
NAIL & TAG 18998 IN NORTH SIDE OF GATE POST, 268° NAZ., 74.55'
NAIL & TAG 18998 IN EAST SIDE OF 24" HICKORY, 41° NAZ., 190.63'
NAIL & TAG 18989 IN EAST SIDE OF 20" HICKORY, 171° NAZ., 125.53'
NAIL & TAG 18989 IN WEST ROOT OF 29" HICKORY, 173° NAZ., 270.71'

Signed by Ronald L. Enger Date OCTOBER 28, 1996
28409

Surveyor's Michigan License No. _____

P.A. 345 INGHAM COUNTY
PEER APPROVED 11/14/96 ME

C-1 T4N R2E
PART A CONTINUED:

2. T. J. BROWN, DEPUTY COUNTY SURVEYOR, USED CORNER IN A SURVEY RECORDED IN VOLUME 3, PAGE 15, COUNTY SURVEYOR'S RECORD ON SEPTEMBER 2, 1864 WITH NO MENTION OF MONUMENT OR WITNESSES.
 3. MARK VAN RAEMDONCK, PS #24622, CALLS FOR C-13 PERRY TOWNSHIP IN AN UNRECORDED SURVEY DATED FEBRUARY 1994:
REROD
EAST 33.00 REROD
S50°E 24.32' 4" STEEL FENCE POST
WEST 2593.54 R & C #24622 AT SOUTH 1/4 CORNER SECTION 31
N01° 23' 24"E 2644.85' 1" PIN AT EAST 1/4 CORNER SECTION 31
 4. MARV FOUTY, PS #18989, TRAVERSED SECTION DURING THE 1994 REMONUMENTATION PROGRAM.
 7. DURING AN ENGER SURVEYING PROJECT IN APRIL 1995, DAVID CLIFFORD, PS #25837, FOUND VAN RAEMDONCK'S BAR AT C-13 PERRY TOWNSHIP. AT THIS TIME ENGER SURVEYING, USING M. FOUTY'S 1994 TRAVERSE TIED INTO ALL OCCUPATION LINES THAT MIGHT AFFECT THE LOCATION OF THE CORNER.
 8. AT THE SAME TIME D. CLIFFORD WAS WORKING IN SECTION 5 OF LOCKE TOWNSHIP, JEFF AUTENRIETH, PS #31588 OF BRYAN LAND SURVEYS, WAS WORKING IN SECTION 32 OF PERRY TOWNSHIP. D. CLIFFORD EXCAVATED A VERY LARGE AREA IN SEARCH OF EVIDENCE C-1 PERRY AND J. AUTENRIETH TIED OCCUPATION TO EAST AT SAME TIME. OCCUPATION TIES LED BOTH CLIFFORD AND AUTENRIETH TO BELIEVE THAT VAN RAEMDONCK'S BAR MARKS THE BEST POSSIBLE LOCATION FOR C-13 PERRY TOWNSHIP. OCCUPATIONAL EVIDENCE OF THE POSITION A-1 LOCKE TOWNSHIP AND G-13 PERRY TOWNSHIP THAT WAS IN GOOD PRORATIONAL MEASUREMENT TO VAN RAEMDONCK'S BAR SUPPORTED THIS ASSUMPTION. D. CLIFFORD ACCEPTED THE GLO FALLING DISTANCE AND VAN RAEMDONCK'S POSITION OF C-13 PERRY AS THE BEST EVIDENCE OF THE ORIGINAL POSITION OF THIS CORNER AND ACCORDINGLY RE-ESTABLISHED C-1 AT 99.00' EAST OF C-13 PERRY AND MONUMENTED THE AMENDED CORNER POSITION (USING VAN RAEMDONCK'S BAR AT C-13, T5N, R2E AND 1/2" BAR AND CAP PS #25832 AT D-13, T5N, R2E) WITH A 3/4" DIAMETER X 24" LONG SMOOTH STEEL BAR AND CAP LS 28409. HE REPLACED VAN RAEMDONCK'S 1/2" REBAR WITH A 5/8" REBAR AND CAP LS #28409.
- 5/8" REBAR & CAP #28409 (C-13 PERRY TOWNSHIP), WEST, 99.00'
NAIL & TAG 18998 IN NORTH SIDE OF GATE POST, 268° NAZ., 74.55'
NAIL & TAG 18998 IN EAST SIDE OF 24" HICKORY, 41° NAZ., 190.63'
NAIL & TAG 18989 IN EAST SIDE OF 20" HICKORY, 171° NAZ., 125.53'
NAIL & TAG 18989 IN WEST ROOT OF 29" HICKORY, 173° NAZ., 270.71'