

# SURVEY & REMONUMENTATION

OCT 1 1 1994

COMMISSION

## MACKINAC COUNTY REMONUMENTATION CORNER LAND CORNER RECORDATION CERTIFICATE Filing Requirement of Act 74, Mich. P.A. 1970

For corners in

Mackinac <small>(County)</small>	Located In:	Corner Code #	
1. Public Land Survey	T <u>40N</u> R <u>4W</u>	<u>E-4</u>	
	T _____ R _____	_____	
	T _____ R _____	_____	
	T _____ R _____	_____	
2. Property Controlling in Section	S _____ T _____ R _____	_____	
	S _____ T _____ R _____	_____	
3. Miscellaneous Property in Sec.	S _____ T _____ R _____	_____	
	S _____ T _____ R _____	_____	
4. Lot No. _____, Recorded Plat _____			
5. Private Claims _____			

**RECEIVED & FILED**  
DIANE FRANKOVICH  
MACKINAC COUNTY REGISTER OF DEEDS

SEP 6 1994  
AM \_\_\_\_\_ PM \_\_\_\_\_  
7|8|9|10|11|12|1|2|3|4|5|6|7|8|9|0

Register of Deeds Stamp & File Number

I, Neil E. Hill, in a field survey on August 22, 1994, do hereby certify that under requirements of P.A. 74, Michigan P.A. of 1970, the corner points mentioned in lines 1 and 2 above were in conformance with regulations and rules therefore as required in the current manual of survey instructions of the United States Department of the Interior, Bureau of Land Management or by a decree of a Court of Law and/or that the corner points mentioned in lines 3, 4 and 5 above were in conformance with the rules of the Michigan Board of Land Surveyors or by a Decree of a Court of Law; established, re-established, monumented, re-monumented, recovered, found as expressed below:

**NOTE: Not more than 4 corners, all in the same town and range, may be recorded on this certificate.**

	A	B	C	D	E	F	G	H	I	J	K	L	M
2	6		5		4		3		2		1		
3													
4	7		8	●	9		10		11		12		
5													
6	18		17		16		15		14		13		
7													
8	19		20		21		22		23		24		
9													
10	30		29		28		27		26		25		
11													
12	31		32		33		34		35		36		
13													

A. Description of original monument and accessories and/or subsequent restoration:

Set post  
Tied 16" Fir N20E 0.15 ch  
18" Fir S35W 0.10 ch

B. Description of corner evidence found and/or method applied in restoring or reestablishing corner:

No record on this corner  
1978 MDOT tied and used this corner; 1" iron pipe  
1994 Not recorded  
MDOT witnesses:  
18" Maple N25W 24.70'  
6" W. Birch N30E 33.71'  
14" Maple East 08.88'  
8" Beech S20W 08.51'

ACCEPTED BY THE MACKINAC COUNTY  
SURVEY PEER GROUP AS THE  
OFFICIAL CORNER UNDER P.A.  
345 OF 1990 AT A MEETING  
HELD ON 8-16-94

*James A. Granger*

C. Description of monument for corner and accessories established to perpetuate locating the position of the corner:

Accepted corner as found.  
Placed 5/8" re-rod with 4" aluminum cap inside 1" iron pipe.  
Corner is 1.7' out of ground.  
20" Maple N25W 24.75' (MDOT tag)  
8" W. Birch N30E 33.70' (MDOT tag)  
18" Maple East 08.75' dead (MDOT tag)  
16" Beech S20W 08.60' dead (MDOT tag)

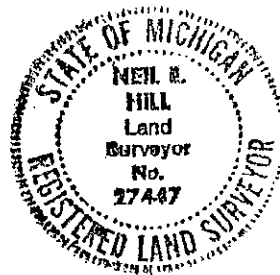

Signed by Neil E. Hill P.S. Date August 22, 1994  
Surveyor's Michigan License No. 27447

D-0275

09-06-94 1CL3183

MSR

2.00

09-06-94

1CL3183

FILE FEE  
M.S.S.