

SURVEY & REMONUMENTATION

MAY - 1 1995

COMMISSION

LIBER **15288** PG **492**

MAR 10 95 040406

\$ 7.00 MISC RECORDING CHG - IN HOUSE
 \$ 2.00 REMON CHG - IN HOUSE
 MAR 95 3:39 P.M. RECEIPT# 1778
 PAID RECORDED - OAKLAND COUNTY
 LYNN D. ALLEN, CLERK/REGISTER OF DEEDS

LAND CORNER RECORDATION CERTIFICATE
Filing Requirement of Act 74, Mich. P.A. 1970
 Commerce Twp.

For corners in Oakland

(County)	Located In:	Corner Code #
1. Public Land Survey	T 2N R 8E	I-5
	T R	
	T R	
	T R	
2. Property Controlling in Section	S T R	
	S T R	
3. Miscellaneous Property in Sec.	S T R	
	S T R	

OK - T. SMITH
 Compliance with
 ACT 345, P.A. 1990

APPROVED ON: 12-13-94
**OAKLAND COUNTY REMONUMENTATION
 PEER GROUP COMMITTEE**

Register of Deeds Stamp & File Number

4. Lot No. _____, Recorded Plat _____
 5. Private Claims _____

David Pawlaczyk November 24 94

I, _____, in a field survey on _____, 19 _____, do hereby certify that under requirements of P.A. 74, Michigan P.A. of 1970, the corner points mentioned in lines 1 and 2 above were in conformance with regulations and rules therefore as required in the current manual of survey instructions of the United States Department of the Interior, Bureau of Land Management or by a decree of a Court of Law and/or that the corner points mentioned in lines 3, 4 and 5 above were in conformance with the rules of the Michigan Board of Land Surveyors or by a Decree of a Court of Law; established, re-established, monumented, re-monumented, recovered, found as expressed below:

NOTE: Not more than 4 corners, all in the same town and range, may be recorded on this certificate.

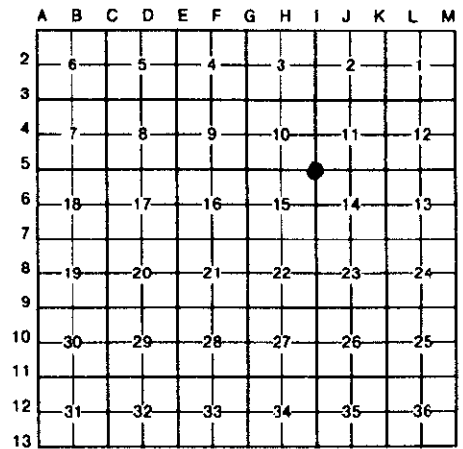

A. Description of original monument and accessories and/or subsequent restoration:

1815 Post G.L.O. A. Holmes N/A Notes

B. Description of corner evidence found and/or method applied in restoring or reestablishing corner:

A 1" iron rod 0.1' below top of asphalt pavement currently occupies this corner. No L.C.R.C. was ever recorded as of this date. Ties were made to log cabin beach subdivision and shown to be 32.80' east of east line adjacent subdivision block.

Field measurements were made between the following corners:

I-6 to I-5	2658.91	meas.		
	2640.00	rec.	G.L.O.	Notes
	2658.89	rec.	plats	L215 P12-16
I-5 to I-4	2631.04	meas.		
	2640.00	rec.	G.L.O.	Notes

7.00
2.80

C. Description of monument for corner and accessories established to perpetuate locating the position of the corner:

I replaced the 1" iron rod with a 5/8" x 24" iron rod with 2" diameter brass cap stamped "Oakland County Remonumentation PS #17632" with a new monument box.

S.72° W.	36.17'	P.K. nail and O.C.R. tag S.E. face Twin 8" Hickory
S.25° W.	73.84'	P.K. nail and O.C.R. tag S.E. face 12" Poplar
S.26° E.	64.72'	P.K. nail and O.C.R. tag in S.W. face 8" Ash
N.72° E.	65.32'	P.K. nail and O.C.R. tag in S. face 14" Ash
N.62° E.	41.29'	P.K. nail and O.C.R. tag S.E. face 16" Ash

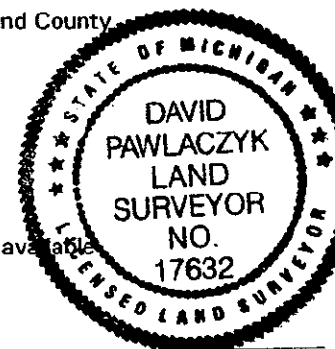

The selected location is accepted by me and generally accepted by Professional Surveyors as the best available evidence of the position of the original corner.

Signed by _____

Date 2-16-95

Surveyor's Michigan License No. 17632