

RAIITIED BY THE BERRIEN COUNTY
SURVEY PEER GROUP AS THE
OFFICIAL CORNER UNDER MICHIGAN
PUBLIC ACT 345 OF 1990

09/02/94

111#2445

33

09/02/94

CORNER

\$9.00

111#2445

A33

STATE REMON FEE \$2.00

BERRIEN COUNTY REMONUMENTATION
LAND CORNER RECORDATION CERTIFICATE
Filing Requirement of Act 74, Mich. P.A. 1970

RECEIVED
REGISTER OF DEEDS
BERRIEN COUNTY MICHIGAN
SEP 2 4 21 PM '94

RECORDED

For corners in

Berrien
(County)

Located In:

Corner Code ##

- | | | | | | |
|---------------------------------------|---|----|---|-----|------|
| 1. Public Land Survey | T | 5S | R | 19W | H-12 |
| | T | | R | | |
| | T | | R | | |
| | T | | R | | |
| | T | | R | | |
| 2. Property Controlling
in Section | S | | T | R | |
| | S | | T | R | |
| 3. Miscellaneous | S | | T | R | |
| Property in Sec. | S | | T | R | |

Register of Deeds Stamp & File Number

4. Lot No. _____, Recorded Plat _____
5. Private Claims _____

I, John G. Kamer, in a field survey on August 24, 19 94,
do hereby certify that under requirements of P.A. 74, Michigan P.A. of 1970, the corner points mentioned
in lines 1 and 2 above were in conformance with regulations and rules therefore as required in the
current manual of survey instructions of the United States Department of the Interior, Bureau of Land
Management or by a decree of a Court of Law and/or that the corner points mentioned in lines 3, 4 and 5
above were in conformance with the rules of the Michigan Board of Land Surveyors or by a Decree of a
Court of Law; established, re-established, monumented, re-monumented, recovered, found as
expressed below:

**NOTE: Not more than 4 corners, all in the same town and range, may be recorded
on this certificate.**

A. Description of original monument and accessories and/or subsequent restoration:

(See Back)

B. Description of corner evidence found and/or method applied in restoring or reestablishing corner:

Found 1" square iron drag tooth.

The perpetuation of the corner as evidenced by the history of witness ties
appears reliable and accurate.

	A	B	C	D	E	F	G	H	I	J	K	L	M
2	6		5		4		3		2		1		
3													
4	7		8		9		10		11		12		
5													
6	18		17		16		15		14		13		
7													
8	19		20		21		22		23		24		
9													
10	30		29		28		27		26		25		
11													
12	31		32		33		34		35		36		
13													

C. Description of monument for corner and accessories established to perpetuate locating the position of the corner:

Set standard 3' conc mon w/brass plate
in place of 1" square iron drag tooth.
Set nail w/tag in 18" oak S82E 96.81
Set nail w/tag in 14" oak S69E 82.49
Set nail w/tag in wood post S74W 10.73
Set nail w/tag in 7" hawthorne cluster S79W 5.88

This position not established by original
government surveyors. This monument is
accepted as the best available evidence
of the corner.

(The mathematical intersection of the 1/4 lines
is 2.53'S. and 0.36'W. of the corner).

Signed by John G. Kamer
Surveyor's Michigan License No. 27449

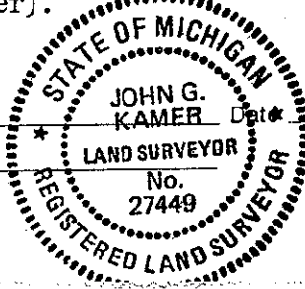

FORM APPROVED BY MICHIGAN STATE BOARD OF LAND SURVEYORS, JAN. 28, 1971
REVISED MAY 14, 1975
REVISED JAN., 1983

LIBER

3 PAGE 159

1910

Found Iron
1317' E to 1/8 In.

1965

W & A (Notes)
Found Bolt

Jan 9, 1973

W & A
Found Bolt
N. Post of Shelter S 50° W 11.3
3" Oak S 80° E 96.8'
IP W 176.50'

July 29, 1971

E.R. Stefen Lb. 903 pg. 936
Fnd Spring
Roof Brace N 40° W 13.45'
R.R. Tie SE Cor. Bldg. S 15° W 35.1'
Eave Line W 1.5'

Dec. 6, 1973

Stefen Lb. 966 pg. 826
Center Section
(Spring drag tooth)
Face 6" Oak East 96.0'
Cor. R.R. Tie West 4.8'
N.E. Cor. R.R. Tie
Post 8.8'

June 17, 1976

Rushlow (W & A)
Fnd. ?

1980

Stefen Lb. 1137 Pg. 418 LCRC 2 pg. 352
Fnd. Spring Drag Tooth
Face 6" Oak East
Cor. R.R. Tie West
N.E. Cor. R.R. Tie

May 8, 1987

Kamer (W & A)
Center 34-5-19
FD. Stone

May 21, 1987

Kamer
Center 34-5-19
Found Stone

May 18, 1989

Kamer
Center Section 34-5-19
PK in 14" Oak S 85° E 97.17'
PK in 10" Oak S 75° E 82.58'
PK in Old Fence Post S 80° W 10.97'

June 4, 1990

John G. Kamer
Center Sec. 34
Fnd. Spring Drag Tooth
PK in 15" Oak S 80° E 96.70'
PK in 12" Oak S 65° E 82.60'
PK in Wood Fence Post S 80° W 10.70'

March 26, 1991

Kamer
Center Sec. 34-5-19
Fnd. Spring Drag Tooth
P.K. in 15" Oak S 80° E 96.70'
P.K. in 12" Oak S 65° E 82.60'
P.K. in Wood Fence Post S 80° W 10.70'

SURVEY &
REMONUMENTATION

NOV 07 1994

COMMISSION