

MICHIGAN
DEPARTMENT OF CONSERVATION
FORESTRY DIVISION

LAND CORNER RECORD

T. 34 N.R. 3 W

Cheboygan COUNTY

DESCRIPTION OF CORNER Section corner common to Sections 15-16-21-22

CORNER MONUMENT 1" pipe with 4" brass cap, 6" below surface.

DATE MONUMENT PLACED AND WITNESSED 6/27/61

WITNESSES TO CORNER.....

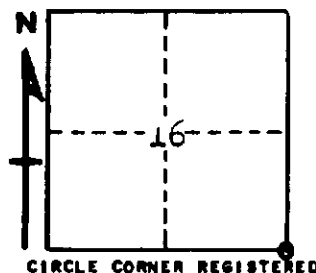

5" Elm - N59W - 37.2 ft

7" H. Maple - N63E - 38.7 ft

AND

DESCRIPTION IN DETAIL AS TO HOW CORNER WAS LOCATED AND IDENTIFIED OR RESTORED.

This corner was set by double proportionate measurement between corners 1 mile south, 3 miles north, 1 mile east, and 1 mile west. Falls nearly in center of E-W Berry Creek road. Could find no indication of previous corner, and all evidence of gov't BTs gone.

SURVEYOR'S SEAL

SIGNED Kenneth J. Oetting DATE 7/5/61
REGISTERED LAND SURVEYOR