

MICHIGAN  
DEPARTMENT OF CONSERVATION  
FORESTRY DIVISION

LAND CORNER RECORD

T. 35 N. R. 1 W

Cheboygan COUNTY

DESCRIPTION OF CORNER M.C. corner common to sections 26-35 on East side Stony Creek Flooding

CORNER MONUMENT Set 1" x 24" pipe and post

DATE MONUMENT PLACED AND WITNESSED June 16, 1966

WITNESSES TO CORNER.....

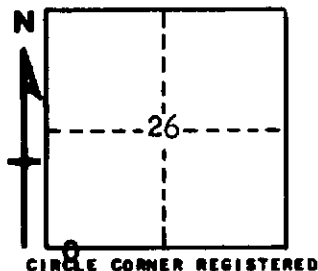

BT 5" W. Pine S 23 W 18.0'

BT 7" S. MAPLE S 72 E 55.7'

AND

DESCRIPTION IN DETAIL AS TO HOW CORNER WAS LOCATED AND IDENTIFIED OR RESTORED.

This corner was set to identify true section line, and to witness the theoretical section corner which falls in flooded area.

Corner is 7.25 ch east of section corner in lake.

SURVEYOR'S SEAL

SIGNED Kenneth Postling DATE June 20, 1966  
REGISTERED LAND SURVEYOR #10068