

MICHIGAN  
DEPARTMENT OF CONSERVATION  
FORESTRY DIVISION

# LAND CORNER RECORD

T. 39 N.R. 3 W

Cheboygan COUNTY

DESCRIPTION OF CORNER Closing Corner common to Sections 27-34 on SE boundary  
of Private Claim #334

CORNER MONUMENT 1" pipe with 4" brass cap

DATE MONUMENT PLACED AND WITNESSED 6/30/61

WITNESSES TO CORNER.....

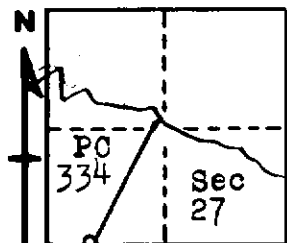

12" Spruce - N53W - 14.2 ft

7" Spruce - N86E - 28.2 ft

AND

DESCRIPTION IN DETAIL AS TO HOW CORNER WAS LOCATED AND IDENTIFIED OR RESTORED.

This corner was restored by Forestry Division survey crew while making a survey in this area. Set corner at record measurement NE from closing corner between Sections 33-34, on calculated SE boundary of Private claim. Unable to identify US BTs. This position would make the mile between 27-34 somewhat short of record, but would conform acceptably for bearing.

SURVEYOR'S SEAL

SIGNED

*Kimberly Bethune*  
REGISTERED LAND SURVEYOR

DATE 7/5/61