

SURVEY & REMONUMENTATION

JAN 11 2001

FILED

copy

SECTION

LAND CORNER RECORDATION CERTIFICATE
Filing Requirement of Act 74, Mich. P.A. 1970

00 AUG -8 PM 2: 15

For corners in HAMLIN TOWNSHIP

EATON COUNTY

Located In:

Corner Code #

1. Public Land Survey T 1N R 3W M-9
T R
T R
T R
2. Property Controlling S T R
in Section S T R
3. Miscellaneous S T R
Property in Sec. S T R

LINDA M. TWITCHELL
REGISTER OF DEEDS
EATON COUNTY, MICH.

LIBER 1 PAGE 125
Register of Deeds Stamp & File Number

4. Lot No. , Recorded Plat
5. Private Claims

I, Maurice H. Mahieu, in a field survey on June 30, 2000, do hereby state that under requirements of P.A. 74, Michigan P.A. of 1970, the corner points mentioned in lines 1 and 2 above were in conformance with regulations and rules therefore as required in the current manual of survey instructions of the United States Department of the Interior, Bureau of Land Management or by a decree of a Court of Law and /or that the corner points mentioned in lines 3, 4 and 5 above were in conformance with the rules of the Michigan Board of Land Surveyors or by a Decree of a Court of Law; established, re-established, monumented, recovered, found as expressed below:

NOTE: Not more than 2 corners, all in the same town and range, may be recorded on this certificate.

A. Description of original monument and accessories and/or subsequent restoration:

1. Original Corner set by John Mullett D.S. in 1825 at a distance of 80.00 chains from M-11. "Set post cor secs 24 & 25. W Oak 20 S 33° W 106. Do 48 N 3° W 89." Ingham County Records for Onondaga Twp. indicate a falling of 12 links South (7.92').
2. Volume 1, Page 53 of Eaton County Surveyors' Records shows a survey by J.H. Gibbons C.S. in April 1869 in which he described the corner as a stone and crockery. No measurements or witnesses.
3. Volume 4, Page 24 of Eaton County Surveyors' Records shows a survey by Morrell E. Newcomb on May 25, 1907 in which he describes the corner as a stone with brick and crockery measuring 2649.24' from L-9. No Witnesses.
4. Notes in the G.L.O. margin with Newcomb's name are the following witnesses: W. Oak 36" Northeasterly 38.00'. Sugar 12 Southeasterly 71.00'. Also, there's a note indicating the corner for Onondaga Twp. (A-9) is 12 links (7.92') South.

(Continued On Back)

B. Description of corner evidence found and/or method applied in restoring or reestablishing corner:

Found two large spikes in a monument box at the intersection of the centerlines of Waverly and Bellevue Roads. Found all accessories described in Liber 3, Page 38 (A.6), and found that neither spike was in the described position. Excavated a 2' x 2' area around monument box to a total depth of ±3.5', at which original clay road bed was uncovered. Found no other evidence of prior monumentation. Accepted the position described by Surveyor Bryan in Liber 3, Page 38 as the best perpetuated location for the corner. Re-established this position off of remaining accessories and in it set a 3/4" x 24" iron form pin with a 2 1/2" diameter aluminum P.A. 345 cap #28414.

C. Description of monument for corner and accessories established to perpetuate locating the position of the corner:

A 3/4" x 24" iron form pin with a 2 1/2" diameter Aluminum Cap #28414 in a monument box in the intersection of the centerlines of Waverly and Bellevue Roads, witnessed by:
Found P.K. Nail in East side Power Pole N 30° E 50.59'
Found R.R. Spike at A-9, T1N, R2W, South 7.92'
Found Centerline 4" diameter steel post at ground S 40° E 50.99'
Northeast Corner Stone House Foundation S 52° W 157.02'

Signed by Maurice H. Mahieu
Surveyor's Michigan License No. 28414

Date 8-03-00

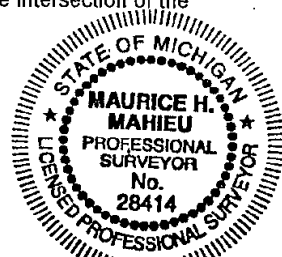

FORM APPROVED BY MICHIGAN STATE BOARD OF PROFESSIONAL SURVEYORS, JAN. 28, 1971
REVISED MAY 14, 1975

P.A. 345 EATON COUNTY
PEER APPROVED 8/6/2000 RL

REVISED JAN., 1993
REVISED OCT., 1995

(A - Continued)

5. Notes in the G.L.O. margin initialed H.A.W. 1926 show witnesses: Hickory N 58 1/2° W 44.0'. Stone (BM) Northwest 31.3'.
6. A L.C.R.C. recorded in Liber 3, Page 38 by Lary A. Bryan L.L.S. #25832 on August 17, 1987 claims, "Original Monument & Accessories Obliterated." Monumentation described as a Found 1/2" Bar. Witnesses: Found P.K. Nail in East side Power Pole N 30° E 50.59'; centerline 4" diameter steel anchor post S 40° E 51.08'. Found R.R. Spike at Northwest Corner of Section 30, T1N, R2W, South 7.92'.
7. An Act 132 survey recorded in Liber 2, Page 701 by Laveme J. Hendryx R.L.S. #3276 on October 19, 1978 shows he measured the corner 2647.00' from L-9 and 7.92' from A-9, Onondaga Twp., monumentation description and witnesses not given.
8. An Act 132 survey recorded in Liber 2, Page 702 by Laveme J. Hendryx R.L.S. #3276 on October 19, 1978 shows same measurements as in A.7. Monumentation description and witnesses not given.

**SURVEY &
MONUMENTATION**

JAN 11 2001

SECTION