

MICHIGAN  
DEPARTMENT OF CONSERVATION  
FORESTRY DIVISION

# LAND CORNER RECORD

T. 26 N. R. 9 W  
T 26 N R 10 W Grand Traverse COUNTY

DESCRIPTION OF CORNER Section corner common to sections 30 - 31 - 25 - 36

CORNER MONUMENT Left  $1\frac{1}{4}$ " pipe in place.

DATE MONUMENT PLACED AND WITNESSED 8-28-63

WITNESSES TO CORNER.....

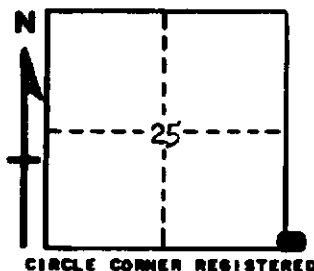

10" Maple - N 35 E - 76.4

8" W. Oak - S 57 W - 48.8

AND

DESCRIPTION IN DETAIL AS TO HOW CORNER WAS LOCATED AND IDENTIFIED OR RESTORED.

This corner was found while making a survey of Section 25. Found  $1\frac{1}{4}$ " pipe in place at road intersection N-S-E, and in line with old fence west. Established in previous survey by unknown surveyor, possibly Marcus Schaaf, R.L.S. Appears to be properly located.

SURVEYOR'S SEAL

SIGNED Kenneth J. Ostberg #10068 DATE 9/18/63  
REGISTERED LAND SURVEYOR