

MICHIGAN
DEPARTMENT OF CONSERVATION
FORESTRY DIVISION

LAND CORNER RECORD

27
T. 26 N.R. 9 W

GRAND TRAVERSE COUNTY

DESCRIPTION OF CORNER Sec. corner common to sections 31 & 32, 5 & 6

CORNER MONUMENT Found square concrete monument with Cedar guard post

DATE MONUMENT PLACED AND WITNESSED 8/15/68

WITNESSES TO CORNER.....

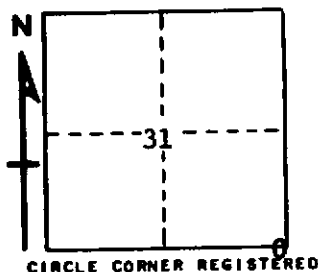

6" Oak	N 40 E	18.7'
9" Twin W Pine	S 15 E	27.4'
6" Oak	S 20 W	7.2'
E-W Random	Due S.	4.4'

AND Corner is origin for Random South

DESCRIPTION IN DETAIL AS TO HOW CORNER WAS LOCATED AND IDENTIFIED OR RESTORED.

This corner was found and accepted. Schaaf notes dated 1933 show he had original corner here. Found Pine stump remains for probable USBTs SE & NE. NW pine stump would fit, except it is 10 links long. This corner also fits survey by Carver dated 1927. Mea. N. 495'± & found remains of pine stk. about 0.5' deep from Y. Pine stump remains of probable USBTs. This fits Schaaf data.

SURVEYOR'S SEAL

SIGNED Carl F. Rosen DATE 8/15/68
REGISTERED LAND SURVEYOR #12028