

MAY 07 1997

COMMISSION

LAND CORNER RECORDATION CERTIFICATE

Filing Requirement of Act 74, Mich. P.A. 1970

For corners in

Grand Traverse
(County)

Located In:

Corner Code #

1. Public Land Survey

T 28N R 9W

C-6

T R

T R

T R

2. Property Controlling
in Section

S T R

S T R

3. Miscellaneous

S T R

Property in Section

S T R

4. Lot No. , Recorded Plat

5. Private Claims

STATE OF MICHIGAN
GRAND TRAVERSE COUNTY
RECORDED

30 DEC 1996 12:25 P.M.

KARON ANDERSON
REGISTER OF DEEDS

Register of Deeds Stamp & File Number

I, Robert F. Mitchell in a field survey on November, 19 96, do hereby certify that under requirements of P.A. 74, Michigan P.A. of 1970, the corner points mentioned in lines 1 and 2 above were in conformance with regulations and rules therefore as required in the current manual of survey instructions of the United States Department of the Interior, Bureau of Land Management or by a decree of a Court of Law and/or that the corner points mentioned in lines 3, 4 and 5 above were in conformance with the rules of the Michigan Board of Professional Surveyors or by a Decree of a Court of Law; established, re-established, monumented, re-monumented, recovered, found as expressed below:

NOTE: Not more than 4 corners, all in the same town and range, may be recorded on this certificate.

A. Description of original monument and accessories and/or subsequent restoration:

C-6) 1/4 Cor common to Secs 17 & 18, T28N-R9W; "A 2 1/2" x 30" flanged bottom galvanized iron pipe with a 3 1/2" brass cap stamped GRAND TRAVERSE CO REMONUMENTATION, in a monument box, 2" below the surface of a North-South black top road", a LCR by Robert F. Mitchell, recorded under the Grand Traverse County Remonumentation plat and approved by the peer review group on Nov 7, 1995 and recorded in L.3, Pg.628 of the LCR's of Grand Traverse Co. A complete history of this cor is recorded on this Land Cor Certificate.

B. Description of corner evidence found and/or method applied in restoring or reestablishing corner:

C-6) 1/4 Cor common to Secs 17 & 18, T28N-R9W; Bates Road went through a major reconstruction project in the Fall of 1995 and the Summer of 1996, the existing approved Co. Remon monument was removed and destroyed by this construction. Re-established this corner with a 2 1/2" x 30" flanged bottom galvanized iron pipe with a 3 1/4" brass Cap stamped GRAND TRAVERSE COUNTY REMONUMENTATION, 4" below the surface of an North-South black top road, in a monument box, from 3 remaining wits of the previously recorded Remonumentation LCR as recorded in L.3, Pg.628 and is accepted as a careful and faithful perpetuation of the position of the original corner, as documented in L.3, Pg.628 of the LCR's of Grand Traverse Co.

C. Description of monument for corner and accessories established to perpetuate locating the position of the corner:

C-6) 1/4 Cor common to Secs 17 & 18, T28N-R9W;

A 2 1/2" x 30" flanged bottom galvanized iron pipe with a 3 1/4" brass Cap stamped GRAND TRAVERSE COUNTY REMONUMENTATION, in a monument box, 4" below the surface and 2.5 feet East of the centerline of North-South Bates Road.

S81°W - Power Pole - 29.31' (old wit L.3, Pg.628)
N44°W - 20" Maple - 142.87' (old wit L.3, Pg.628)
N45°E - Service Pole - 115.80' (old wit L.3, Pg.628)
S45°E - 4" Apple - 63.62'

UNANIMOUSLY ACCEPTED BY THE
GRAND TRAVERSE COUNTY PEER
REVIEW GROUP AS THE OFFICIAL
CORNER UNDER MICHIGAN PUBLIC
ACT 345 OF 1990 AT A MEETING
HELD ON 12-13-96

ROBERT F. MITCHELL, P.S., CHAIRMAN

Signed by

Surveyor's Michigan License No. 28417

Date

FORM APPROVED BY MICHIGAN STATE BOARD OF PROFESSIONAL SURVEYORS, JAN. 28, 1971
REVISED MAY 14, 1975
REVISED JAN., 1983

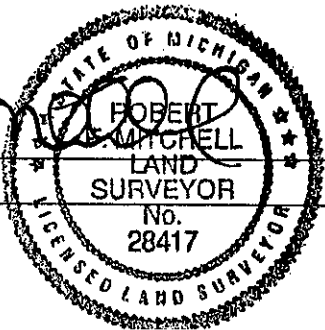

12-13-96