

LAND CORNER RECORDATION CERTIFICATE
Filing Requirement of Act 74, Mich. P.A. 1970 as Amended

For corners in

Houghton (County)	Located In:	Corner Code #
1. Public Land Survey	T _____ R _____ T _____ R _____ T _____ R _____	_____
2. Property Controlling in Section	S 34 T 52N R 35W S 34 T 52N R 35W S _____ T _____ R _____	5 6
3. Miscellaneous Property in Sec.	S _____ T _____ R _____ S _____ T _____ R _____	_____
4. Lot No. _____, Recorded Plat _____		
5. Private Claims _____		

I, Stephan J. Szyszkoski, in a field survey on 5 01/18/2012 do hereby state
that under requirements of P.A. 74, Michigan P.A. of 1970, the corner points mentioned in lines 1 and 2
above were in conformance with regulations and rules therefore as required in the current manual of survey
Instructions of the United States Department of the Interior, Bureau of Land Management or by a decree of
a Court of Law and /or that the corner points mentioned in lines 3, 4 and 5 above were in conformance with
the rules of the Michigan Board of Land Surveyors or by a Decree of a Court of Law; established,
re-established, monumented, recovered, found as expressed below:

NOTE: Not more than 2 corners, all in the same town and range, may be recorded
on this certificate.

A. Description of original monument and accessories and/or subsequent restoration:

(5-Sec. 34) North 1/16 corner, Section 34. 1982 - Established by K.L.Sackett RLS midway and on line
between 1/4 corner to north and Center of Section to south. Set 1"IDx32" iron pipe with 4" alum.
cap. 5" Maple S41W 13.8', 5" Sugar S75E 15.5', 6" Maple N58W 21.4', 10" Aspen squared S25W 2.7'.

(6-Sec. 34) Northeast 1/16 corner of Section 34. Not previously monumented.

B. Description of corner evidence found and/or method applied in restoring or reestablishing corner:

(5-Sec. 34) Found the 1982 monument disturbed and out of position. Only one of the 1982 witnesses
remains and it has been windthrown. Reestablished the position for the corner midway and on a
straight line between 1/4 corner 1084.00' north and Center of Section 34 1084.00' south. Removed the
disturbed 1982 monument.

(6-Sec. 34) Established the position for the corner at the intersection of straight lines connecting
opposite 1/16 corners.

C. Description of monument for corner and accessories established to perpetuate locating the position of the corner:

(5) Set 1"IDx32" I.pipe with 4" alum. MDNR cap.
Set measuring nail with MDNR tag in the side of:
5" Y.Birch N13E 3.5' mrkd "1/16S BT"
6" Maple S37E 12.1' do
8" Y.Birch S06W 25.2' do
6" Hemlock S76W 27.3' do
Set sq'd Cedar post adjacent.
Bearings are magnetic.

(6) Set 1"IDx32" I.pipe with 4" alum. MDNR cap.
Set measuring nail with MDNR tag in the side of:
7" Maple N13E 20.05' mrkd "1/16S BT"
5" Hemlock S80E 10.2' do
7" Maple S50W 9.8' do
7" Maple N75W 9.55' do
Set sq'd Cedar post adjacent.
Bearings are magnetic.

Register of Deeds Stamp & File Number

	A	B	C	D	E	F	G	H	I	J	K	L	M
1													
2	6		5		4		3		2		1		
3													
4	7		8		9		10		11		12		
5													
6	18		17		16		15		14		13		
7													
8	19		20		21		22		23		24		
9													
10	30		29		28		27		26		25		
11													
12	31		32		33		34		35		36		
13													

Signed by Stephan J. Szyszkoski
Surveyor's Michigan License No. 33986

Date 01/31/2012

For the Michigan Department of Natural Resources, Forest Resources Division

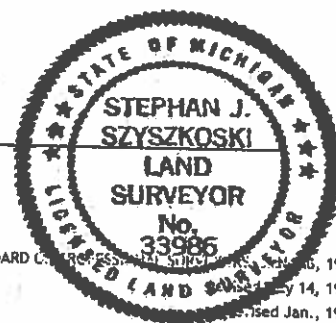

16820

16821