

JAN 19 2001

SECTION

2000 REMONUMENTATION  
LAND CORNER RECORDATION CERTIFICATE  
Filing Requirement of Act 74, Mich. P.A. 1970

For Corners in BINGHAM Township

STATE OF MICHIGAN  
HURON COUNTY  
RECORDED

8 DEC 2000 9:58 AM

FRANCES L. HOLDWICK  
REGISTER OF DEEDS

Register of Deeds Stamp & File Number

Huron  
(County)

Located in:

Corner Code #

- |                           |             |      |
|---------------------------|-------------|------|
| 1. Public Land Survey     | T 15N R 13E | A-12 |
|                           | T — R —     |      |
|                           | T — R —     |      |
|                           | T — R —     |      |
| 2. Property Controlling S | T — R —     |      |
| in Section S              | T — R —     |      |
| 3. Miscellaneous S        | T — R —     |      |
| Property in Sec. S        | T — R —     |      |

4. Lot No. \_\_\_\_\_, Recorded Plat \_\_\_\_\_  
5. Private Claims \_\_\_\_\_

I, Russell L. Brown, in a field survey on June 2, 2000 do hereby state that under requirements of P.A. 74, Michigan P.A. of 1970, the corner points mentioned in lines 1 and 2 above were in conformance with regulations and rules therefore as required in the current manual of survey instructions of the United States Department of the Interior, Bureau of Land Management or by a decree of a Court of Law and/or that the corner points mentioned in lines 3, 4, and 5 above were in conformance with the rules of the Michigan Board of Land Surveyors or by a Decree of a Court of Law; established, re-established, monumented, recovered, found as expressed below:

NOTE: Not more than 2 corners, all in the same town and range, may be recorded on this certificate.

A. Description of original monument and accessories and/or subsequent restoration:

1834 GLO. H. Parke D.S. Set quarter Section Post East side Sec. 36, T15N-R12E, Hemlock 13, N63W 17, Hemlock 8, S14 1/2W 31  
COUNTY SURVEYORS RECORD - None  
COUNTY ROAD COMMISSION RECORD - 31W, no object stated. Witnesses: in line with fences East and West, Telephone Pole S88°W 52.1'  
LCRC - None  
RECORDED SURVEYS - None  
UNRECORDED SURVEYS - None

B. Description of corner evidence found and/or method applied in restoring or reestablishing corner:

No evidence of original Corner or accessories found.

Found 3/4" Dia. Re-Rod in monument box.

Accepted found 3/4" Re-Rod as best evidence of original Corner position.

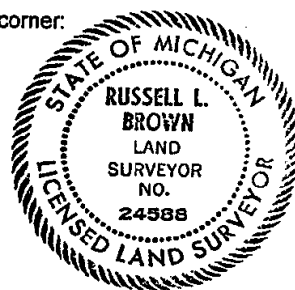

C. Description of monument for corner and accessories established to perpetuate locating the position of the corner:

A-12 West 1/4 Corner Section 31, T15N-R13E

Found 3/4" Re-Rod in Monument Box.

WITNESSES:

N45°E 29.09' to 1/2" Dia. Re-Rod Set  
East 44.08' to Center N.G.S. Triangular Concrete Monument  
S60°E 51.90' to Witness Post for N.G.S. Monument  
West 18.90' to 1/2" Dia. Re-Rod Set  
South 2639.77' A-13, S.W. Cor. Sec. 31, T15N-R13E  
North 2630.67' A- 11, N.W. Cor. Sec. 31, T15N-R13E

NOTE:

This Corner is common  
with M-12, T15N-T12E

Signed by Russell L. Brown  
Surveyor's Michigan License No. 24588

Date Nov. 2, 2000

Peer group approved at meeting held November 2, 2000. RLB