

SURVEY & REMONUMENTATION

JAN 22 1998

SECTION

1997 REMONUMENTATION

LAND CORNER RECORDATION CERTIFICATE Filing Requirement of Act 74, Mich. P.A. 1970

For corners in COLFAX TOWNSHIP

<u>HURON</u> (County)	Located In:	Corner Code #
1. Public Land Survey	T <u>16</u> N R <u>12</u> E	<u>E-13</u>
	T <u> </u> R <u> </u>	<u> </u>
	T <u> </u> R <u> </u>	<u> </u>
	T <u> </u> R <u> </u>	<u> </u>
2. Property Controlling in Section	S <u> </u> T <u> </u> R <u> </u>	<u> </u>
	S <u> </u> T <u> </u> R <u> </u>	<u> </u>
3. Miscellaneous Property in Sec.	S <u> </u> T <u> </u> R <u> </u>	<u> </u>
	S <u> </u> T <u> </u> R <u> </u>	<u> </u>

STATE OF MICHIGAN
HURON COUNTY
RECORDED

12 DEC 97 12:41 P.M.

FRANCES L. HOLDWICK
REGISTER OF DEEDS

Register of Deeds Stamp & File Number

4. Lot No. , Recorded Plat
5. Private Claims

I, Russell L. Brown, in a field survey on Nov. 24, 19 97 do hereby state that under requirements of P.A. 74, Michigan P.A. of 1970, the corner points mentioned in lines 1 and 2 above were in conformance with regulations and rules therefore as required in the current manual of survey instructions of the United States Department of the Interior, Bureau of Land Management or by a decree of a Court of Law and/or that the corner points mentioned in lines 3, 4 and 5 above were in conformance with the rules of the Michigan Board of Land Surveyors or by a Decree of a Court of Law; established, re-established, monumented, recovered, found as expressed below:

NOTE: Not more than 2 corners, all in the same town and range, may be recorded on this certificate.

	A	B	C	D	E	F	G	H	I	J	K	L	M
1													
2		6		5		4		3		2		1	
3													
4		7		8		9		10		11		12	
5													
6		18		17		16		15		14		13	
7													
8		19		20		21		22		23		24	
9													
10		30		29		28		27		26		25	
11													
12		31		32		33		34		35		36	
13													

A. Description of original monument and accessories and/or subsequent restoration:

1834 G.L.O. H. Parke D.S., Set Post Corner Sections 32 and 33,
Elm 16 N78E 25, B. Ash 28 N75W 50.
COUNTY SURVEYORS RECORDS: None
COUNTY ROAD COMMISSIONS RECORDS: No object stated. 27.06' East of Sheridan 4 N.W.
ACT 74 FORM: None
RECORDED SURVEYS: None

B. Description of corner evidence found and/or method applied in restoring or reestablishing corner:

No evidence of original corner or accessories found.
Found 5/8" Re-Rod

Accepted found 5/8" Re-Rod as best evidence of original corner position.

C. Description of monument for corner and accessories established to perpetuate locating the position of the corner

E-13 Corner Sections 32 and 33, T16N-R12E
Found 5/8" Dia. Steel Stake
WITNESSES:
N60°W 77.34' to P.K. Nail in S.W. Side P.P.
N70°E 47.75' to 1/2" x 18" Steel Stake
S70°E 41.33' to 1/2" x 18" Steel Stake
S65°W 77.75' to Nail in South Side P.P.
West 27.14' to 3/4" Re-Rod over 2" Pipe apparent Corner Sections 4 and 5, T15N-R12E
East 2625.46' to South 1/4 Corner Section 33, T16N-R12E, F-13
West 2674.78' to South 1/4 Corner Section 32, T16N-R12E, D-13

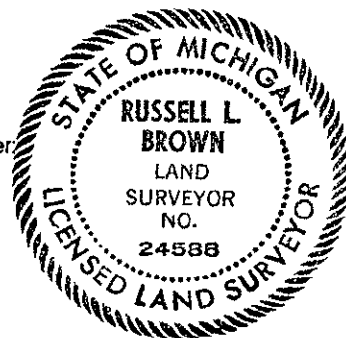

Signed by Russell L. Brown

Date December 9, 1997

Surveyor's Michigan License No. 24588

PEER GROUP APPROVED
AT MEETING HELD

DEC 11, 1997.
RLB