



LIBER 5 PAGE 20

034938

RECORDED
HILLSDALE CO. MICH.

00 OCT 11 AM 10:30

REMONUMENTATION

LAND CORNER RECORDATION CERTIFICATE
Filing Requirement of Act 74, Mich. P.A. 1970

For corners in

HILLSDALE

(County)

Located In:

Corner Code #

1. Public Land Survey

S R 1W C-11

T R

T R

T R

2. Property Controlling
in Section

S T R

S T R

3. Miscellaneous
Property in Sec.

S T R

S T R

SURVEY &
REMONUMENTATION

JAN 12 2001

REGISTERED Needs Stamp & File Number

4. Lot No. _____, Recorded Plat _____

5. Private Claims _____

Jeffrey A. Bieszk

in a field survey on 6 Oct. 2000 do hereby state that under requirements of P.A. 74, Michigan P.A. of 1970, the corner points mentioned in lines 1 and 2 above were in conformance with regulations and rules therefore as required in the current manual of survey instructions of the United States Department of the Interior, Bureau of Land Management or by a decree of a Court of Law and/or that the corner points mentioned in lines 3, 4 and 5 above were in conformance with the rules of the Michigan Board of Land Surveyors or by a Decree of a Court of Law; established, re-established, monumented, recovered, found as expressed below:

NOTE: Not more than 2 corners, all in the same town and range, may be recorded on this certificate.

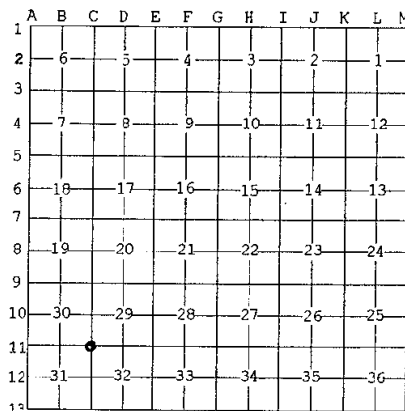

A. Description of original monument and accessories and/or subsequent restoration:

GLO set by Ziba Swan (1824)

Geo. Mark (1867) survey #453 & 454

B. Ash S55W 32 lks.

B. Walnut Stake

B. Ash N65E 19 lks.

20" Locust S61 3/4 E 64 lks

14" B. Ash N82E 70 lks

Robert Burriss LCRC (L1 P459)

chisled "x" on conc. bridge

7' S and 4' E int. of Roads

NW cor. Conc. Post N15E 54.13 ft.

SE cor. Conc. Post N70E 46.50 ft.

SE cor. Conc. Post S27W 47.94 ft.

NE cor. Conc. Post S69W 54.23 ft.

Geo. Mark (1883) survey # 961 a Stake

B. Description of corner evidence found and/or method applied in restoring or reestablishing corner:

Corner is on a concrete Bridge over a creek was re-established by Robert Burriss in his LCRC, accepted as the best available evidence of the position of the original corner.

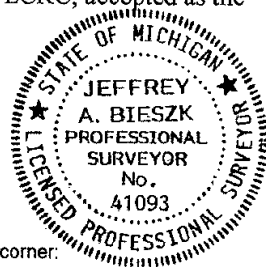

C. Description of monument for corner and accessories established to perpetuate locating the position of the corner:

Set PK at location in concrete Bridge

NW cor. Conc. Post N15E 54.13 ft.

SE cor. Conc. Post N70E 46.50 ft.

SE cor. Conc. Post S27W 47.94 ft.

NE cor. Conc. Post S69W 54.23 ft.

Set 5/8" x 36" iron w/cap in Monument Box
on line C-11 to B-11 and stamped 63.83 ft.Set 5/8" x 36" iron w/cap in Monument Box
on line C-11 to D-11 and stamped 29.65 ft.

Signed by

Surveyor's Michigan License No. 41093Date OCTOBER 11, 2000