

ACCEPTED BY THE HILLSDALE COUNTY  
SURVEY PEER GROUP AS THE OFFICIAL  
CORNER UNDER MICHIGAN PUBLIC ACT  
OF 1890 AT A MEETING HELD

LIBER 5 PAGE 30

034948

RECORDED  
HILLSDALE CO MICH.

60 OCT 11 AM 10:31

REMONUMENTATION

LAND CORNER RECORDATION CERTIFICATE  
Filing Requirement of Act 74, Mich. P.A. 1970

For corners in

HILLSDALE

(County)

Located In:

Corner Code #

1. Public Land Survey

T 8S R 2W A-5

T R

T R

T R

2. Property Controlling  
In Section

S T R

S T R

3. Miscellaneous  
Property in Sec.

S T R

S T R

SURVEY &  
REMONUMENTATION

JAN 12 2001

SECTION

Register of Deeds Stamp & File Number

4. Lot No. , Recorded Plat

5. Private Claims

I, Jeffrey A. Bieszk, in a field survey on 6 Oct. 2000, do hereby state that under requirements of P.A. 74, Michigan P.A. of 1970, the corner points mentioned in lines 1 and 2 above were in conformance with regulations and rules therefore as required in the current manual of survey instructions of the United States Department of the Interior, Bureau of Land Management or by a decree of a Court of Law and/or that the corner points mentioned in lines 3, 4 and 5 above were in conformance with the rules of the Michigan Board of Land Surveyors or by a Decree of a Court of Law; established, re-established, monumented, recovered, found as expressed below:

NOTE: Not more than 2 corners, all in the same town and range, may be recorded on this certificate.

	A	B	C	D	E	F	G	H	I	J	K	L	M
1													
2	6		5		4		3		2		1		
3													
4	7		8		9		10		11		12		
5													
6	18		17		16		15		14		13		
7													
8	19		20		21		22		23		24		
9													
10	30		29		28		27		26		25		
11													
12	31		32		33		34		35		36		
13													

A. Description of original monument and accessories and/or subsequent restoration:

GLO set by Wm. Brookfield. (1825)  
24" W. Oak S50E 72 lks  
16" W. Oak N38 1/2 E 30.5 lks  
10 lks South M-5 T8S-R3W

Geo. Mark (1871) survey #602  
2 Stones & Brick  
7" W. Oak N26°10'E 83.5 lks

Geo. Mark (1905) survey #1241  
Stone, Brick & Earthen  
19" W. Oak N26°10'E 83 lks

B. Description of corner evidence found and/or method applied in restoring or reestablishing corner:

Found R.R. spike 6.7 feet South of M-5 T8S-R3W (remon. iron) GLO is 6.6 feet. Dug under R.R. spike and found nothing. Accepted as the best available evidence of the position of the original corner.

C. Description of monument for corner and accessories established to perpetuate locating the position of the corner:

Set 5/8" x 36" iron w/cap in Monument Box

Stop Sign post	N 10 W	65.54 ft.
Phone riser	N 65 E	103.69 ft.
Phone riser	S 50 W	54.23 ft.
Stop Sign post	S 30 E	45.53 ft.

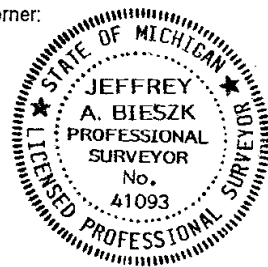

Signed by [Signature]

Surveyor's Michigan License No. 41093

Date October 11, 2000