

# SURVEY & REMONUMENTATION

JAN 13 1998

## SECTION

### LAND CORNER RECORDATION CERTIFICATE Filing Requirement of Act 74, Mich. P.A. 1970

IRON COUNTY  
MICHIGAN  
RECEIVED FOR RECORD

97 DEC 23 PM 1:28

L.C. Records 4.7 P.139

REGISTER OF DEEDS

For corners in

Iron  
(County)

Located In:

Corner Code #

1. Public Land Survey

T 44N R 32W

T 44N R 33W

T R

T R

2. Property Controlling  
in Section

S T R

S T R

3. Miscellaneous  
Property in Sec.

S T R

S T R

A-5  
M-5

Register of Deeds Stamp & File Number

4. Lot No. , Recorded Plat

5. Private Claims

Section Corner Sec. 7, 18, T44N, R32W

Section Corner Sec. 12, 13, T44N, R33W

I, Gary L. Pisoni, in a field survey on November 12, 1997 do hereby state that under requirements of P.A. 74, Michigan P.A. of 1970, the corner points mentioned in lines 1 and 2 above were in conformance with regulations and rules therefore as required in the current manual of survey instructions of the United States Department of the Interior, Bureau of Land Management or by a decree of a Court of Law and/or that the corner points mentioned in lines 3, 4 and 5 above were in conformance with the rules of the Michigan Board of Land Surveyors or by a Decree of a Court of Law; established, re-established, monumented, recovered, found as expressed below:

NOTE: Not more than 2 corners, all in the same town and range, may be recorded on this certificate.

A. Description of original monument and accessories and/or subsequent restoration:

Original corner established in 1846 by Austin Burt, U.S. Deputy Surveyor.

Original Corner: Sugar Post

Original Bearing Trees:

Sugar	14"	S38°E
Elm	14"	N45°W

10 lks.(6.60 feet)  
12 lks.(7.92 feet)

In 1849, Zelotes B. Searls, U.S. Deputy Surveyor, made a new bearing tree:

Sugar	10"	N75°E
-------	-----	-------

25 lks.(16.50 feet)

B. Description of corner evidence found and/or method applied in restoring or reestablishing corner:

No original corner evidence was recovered.

Found fence line North-South and a rock fence line running East. I accept the fence corner intersection as the best available evidence for restoring the corner position.

Corner record research on file with County Representative.

C. Description of monument for corner and accessories established to perpetuate locating the position of the corner:

At the fence corner intersection, set a 3/4 inch outside diameter aluminum rod monument, 3 feet long, 2 inches above the ground surface, with a 3 inch diameter aluminum cap stamped as follows: Iron County Remonumentation, T44N, R32W, R33W, S12, S7, S13, S18, 1997, RLS 27457. Blazed and scribed the following new bearing trees:  
(Measurements are taken to a nail in side of tree)

Sugar Maple	9"	N19°W	46.81 feet
Sugar Maple	9"	S16°W	16.88 feet
White Spruce	9"	S47°W	33.21 feet
White Spruce	14"	S77°W	34.87 feet
Steel Sign Post		N10°W	0.86 feet

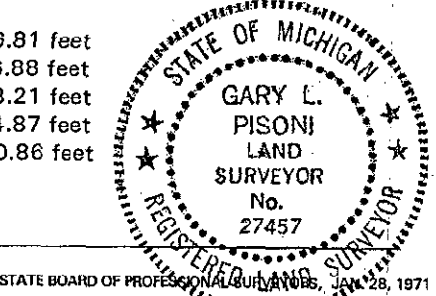

97-34

Signed by Gary L. Pisoni

Date November 29, 1997

Surveyor's Michigan License No. 27457

FORM APPROVED BY MICHIGAN STATE BOARD OF PROFESSIONAL SURVEYORS, JAN 28, 1971  
REVISED MAY 14, 1975  
REVISED JAN., 1983  
REVISED OCT., 1995