

MAR 09 1999

133.13

LAND CORNER RECORDATION CERTIFICATE
Filing Requirement of Act 74, Mich. P.A. 1970
Isabella County Remonumentation

SECTION

For corners in

<u>Isabella</u> (County)	Located In:	Corner Code #
1. Public Land Survey	T13 N R 6W	H-7
	T R	
	T R	
	T R	
2. Property Controlling in Section	S T R	
	S T R	
3. Miscellaneous Property in Sec.	S T R	
	S T R	
4. Lot No. _____, Recorded Plat _____		
5. Private Claims _____		

9800013343
Filed for Record in
ISABELLA COUNTY, MI
SHARON A BROWN
On 12-30-1998 At 10:28:40 am.
RE LAND COR 9.00
OR Liber 1 Page 260 - 260

Register of Deeds Stamp & File Number

	A	B	C	D	E	F	G	H	I	J	K	L	M
2	6	5	4	3	2	1							
3													
4	7	8	9	10	11	12							
5													
6	18	17	16	15	14	13							
7													
8	19	20	21	22	23	24							
9													
10	30	29	28	27	26	25							
11													
12	31	32	33	34	35	36							
13													

I, Timothy E Bebee, in a field survey on December 1, 19 98, do hereby state that under requirements of P.A. 74, Michigan P.A. of 1970, the corner points mentioned in lines 1 and 2 above were in conformance with regulations and rules therefore as required in the current manual of survey instructions of the United States Department of the Interior, Bureau of Land Management or by a decree of a Court of Law and/or that the corner points mentioned in lines 3, 4 and 5 above were in conformance with the rules of the Michigan Board of Land Surveyors or by a Decree of a Court of Law; established, re-established, monumented, recovered, found as expressed below:

NOTE: Not more than 2 corners, all in the same town and range, may be recorded on this certificate.

A. Description of original monument and accessories and/or subsequent restoration:
1837 J. Milroy GLO.....set post
1882 J. Graham CS.....set hemlock stake 4x4
1910 W. Trussell CS.....White oak stake 4x4
1991 G. Gray LCRC 1111.....set iron
1991 G. Gray LCRC unrecorded survey.....set iron

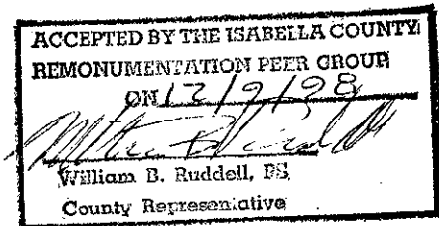

B. Description of corner evidence found and/or method applied in restoring or reestablishing corner:
Found 1/2" capped iron from LCRC 1111 which was set @ single proportionate measure.

C. Description of monument for corner and accessories established to perpetuate locating the position of the corner:
A Remonumentation monument stamped #39074, placed inside a monument box, was set at the position of the corner and is accepted as the best evidence of the perpetuated corner.

Witnesses:

N 52° E 68.24' nail & cap in 6" white pine
S 48° E 79.66' nail & cap in 18" maple
S 76° W 110.69' nail & cap in 10" white pine
N 32° W 56.78' nail & cap in 4" white pine

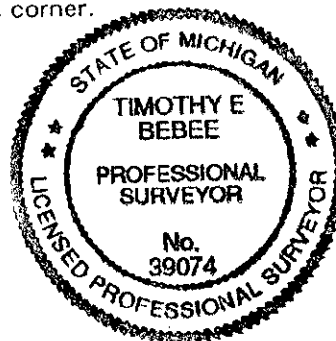

Signed by Timothy E Bebee Date 12/29/98
Surveyor's Michigan License No. 39074