

MICHIGAN
DEPARTMENT OF CONSERVATION
FORESTRY DIVISION

LAND CORNER RECORD

T. 28 N. R. 5 W

KALKASKA COUNTY

DESCRIPTION OF CORNER SEC. CORNER COMMON TO SECTIONS 4-5-8-9

CORNER MONUMENT SET DEPT. MON.

DATE MONUMENT PLACED AND WITNESSED 6-17-69

WITNESSES TO CORNER..... TW 6" Maple N 81 W 19.2

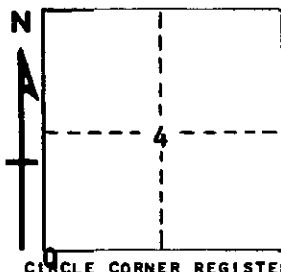

CIRCLE CORNER REGISTERED

TW 8" Maple N 43 E 31.1

5" Maple S 13 E 12.2

AND

Old R.R. Grade South 34.3

DESCRIPTION IN DETAIL AS TO HOW CORNER WAS LOCATED AND IDENTIFIED OR RESTORED.

This corner was restored according to B. L. Caukins record by measurements and offsets from other recovered corners. Unable to positively identify post bottom in disturbed soil, nor B.L.C. BTs, but feel confident corner is recovered as established in 1919 survey. No U. S. evidence left, but Caukins' record claims supporting evidence at nearby corners, and was used in his retracement of this township.

SURVEYOR'S SEAL

SIGNED *Kenneth J. Ostling* DATE 6-23-69
REGISTERED LAND SURVEYOR #10068