

SURVEY & REMONUMENTATION

\$7.00
\$2.00

SEP 18 1995

COMMISSION

For corners in

LAND CORNER RECORDATION CERTIFICATE Filing Requirement of Act 74, Mich. P.A. 1970 KENT COUNTY REMONUMENTATION

STATE OF MICHIGAN
COUNTY OF KENT
RECEIVED FOR RECORD
95 AUG 28 AM 10:46
REC. OF DEEDS
8545

Kent (County)	Located in:	Corner Code #
1. Public Land Survey	T 5N R 12W	A-2
	T R	
	T R	
	T R	
2. Property Controlling in Section	S T R	
	S T R	
3. Miscellaneous	S T R	
Property in Sec.	S T R	

Register of Deeds Stamp & File Number

4. Lot No. _____, Recorded Plat _____
5. Private Claims _____

I, Randy Kolehouse, in a field survey on March 13 19 95, do hereby certify that under requirements of P.A. 74 Michigan P.A. of 1970, the corner points mentioned in lines 1 and 2 above were in conformance with regulations and rules therefore as required in the current manual of survey instructions of the United States Department of the interior, Bureau of Land Management or by a decree of a Court of Law and/or that the corner points mentioned in lines 3, 4 and 5 above were in conformance with the rules of the Michigan Board of Land Surveyors or by a Decree of a Court of Law; established, re-established, monumented, re-monumented, recovered, found as expressed below:

NOTE: Not more than 4 corners, all in the same town and range, may be recorded on this certificate.

A. Description of original monument and accessories and/or subsequent restoration:

A-2	1817	G.L.O. Notes	L. Lyon	Set Post	P.A. 345 1990 KENT COUNTY
	1961	Wit. Map	K.C. Surveyor	1/2" Iron	PEER APPROVED 5/25/95
	1972	L.C.R.C. #250	Williams & Works	1/2" Iron	CHAIRMAN <u>Randy Kolehouse</u>
	1972	L.C.R.C. #152	Medema, Van Kooten & Assoc.	3/4" Iron	
	1981	L.C.R.C. #1549	Nederveld & Jonker	Fnd. Iron in Mon. Box/Set K.C. Monument	
	1988	L.C.R.C. #4665	Olson, Meyers & May	K.C. Monument	

This corner was originally approved by the Kent County Remonumentation Peer Group and monumented by Nederveld & Jonker on 2/3/81 and was recorded per L.C.R.C. #1549.

B. Description of corner evidence found and/or method applied in restoring or reestablishing corner:

A-2 Found standard Kent County Monument in a monument box in the C/L of Kenowa Avenue (N-S) on C/L of 64th Street (East) as set by Nederveld & Jonker on the Town line 0.5' West of closing corner which checked L.C.R.C.'s #152 and #250 and also K.C. Surveyor's records. Monument checks L.C.R.C.'s #1549 and #4665.

L.C.R.C. #1549

L.C.R.C. #4665

Nail & Remon. tag on S side P. pole ENE 53.84'
Nail & Remon. tag on E side P. pole NNE 73.59'
Nail & Remon. tag on S side 26" Maple WSW 57.35'
SE cor. porch NW 96.79'
Ottawa County cor. S 173.0'

Nail & Remon tag on S sde P pole N 70° E 53.84'
Nail & Remon tag on E sde P pole N 35° E 73.59'
Nail & remon tag on S sde 28" Maple S 85° W 57.35'
SE cor hse fndn N 35° W 96.79'
Ottawa County cor S 173.0'

The selected location is accepted by me and is generally accepted by professional surveyors as the best available evidence of the position of the original corner.

C. Description of monument for corner and accessories established to perpetuate locating the position of the corner:

A-2 Standard Kent County Monument
Nail & K.C. remon. tag in S side P. pole N 70° E 53.88'
Nail & K.C. remon. tag in E side P. pole N 35° E 73.80'
Nail & K.C. remon. tag in S side 28" Maple S 85° W 57.35'
SE corner hse. fndn. N 35° W 96.75'
Ottawa Co. corner (E 1/4 Section 1, T5N, R13W) South 173.05'
Closing corner 0.5' East (Not Set)

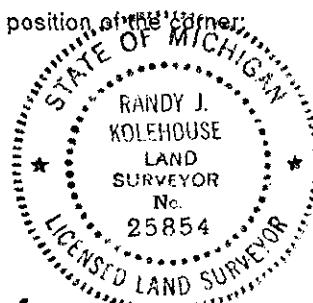

Signed by Randy J. Kolehouse
EARTH TECH

Date 8/21/95

Surveyor's Michigan License No. 25854